

# PROJECT INFORMATION

## NEW STORAGE SHED ADDITION

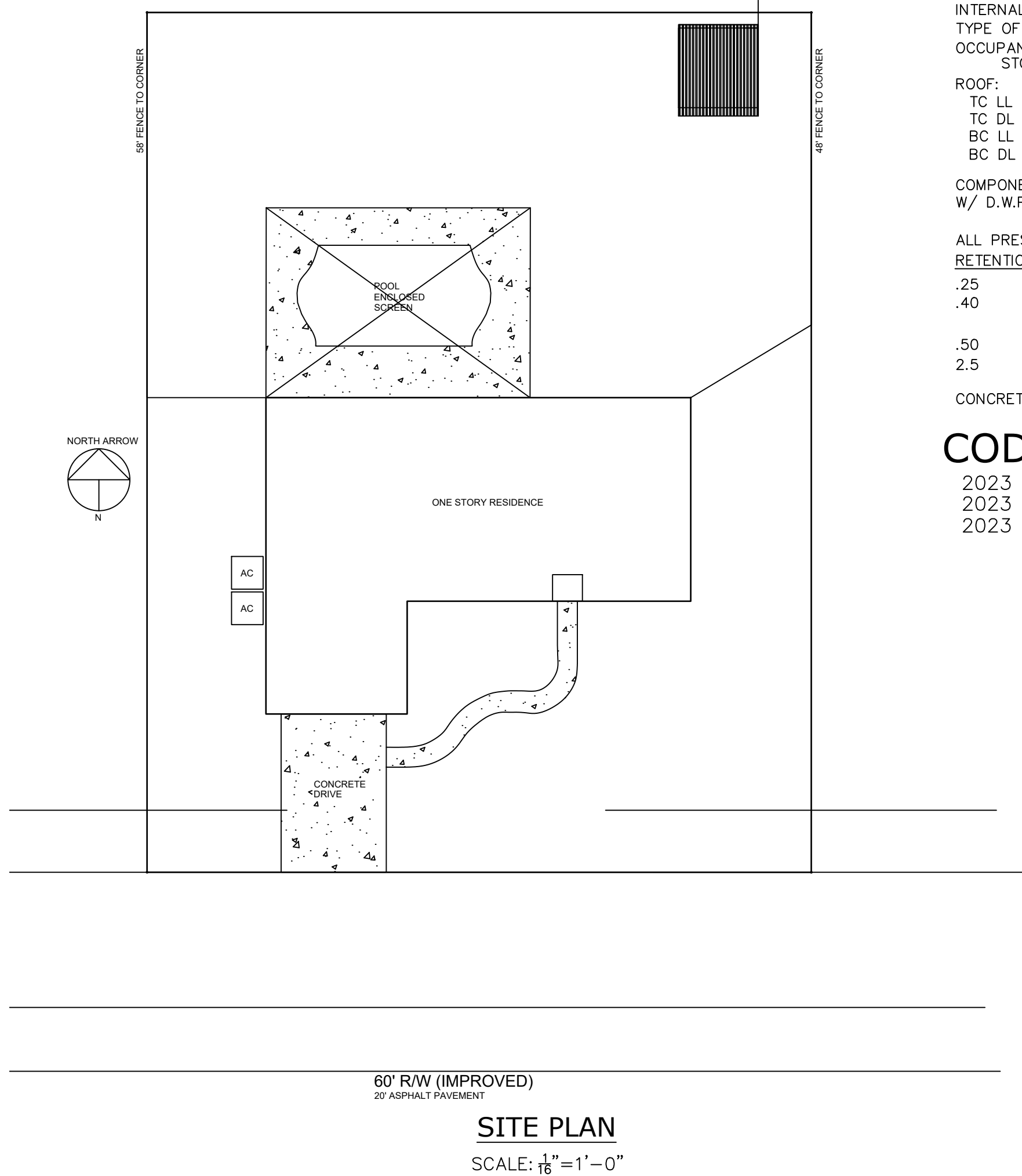

### GENERAL NOTES

- THIS COVER SHEET AND ADDITIONAL ACCOMPANYING ATTACHMENT SHEETS REPRESENT MINIMUM DESIGN REQUIREMENTS FOR CONSTRUCTION OF THE ATTACHED SEALED PLANS IN ACCORDANCE WITH ASCE 7-22, FOR WIND PRESSURES SITED ON BUILDINGS IN THE ULTIMATE 150 MPH WIND ZONE (NOMINAL WIND SPEED 116 MPH) & NEC 2020.
- THE RAISED SEAL SET (OR ELECTRONICS SEALED SET) OF PLANS ARE ON FILE IN THE THIRD PARTY AGENCY'S OFFICE AS DIRECTED BY THE DBPR.
- THIS BUILDING HAS NOT BEEN DESIGNED OR APPROVED FOR PLACEMENT IN HIGH VELOCITY HURRICANE ZONES (HVHZ).
- THE OWNER/CONTRACTOR SHALL VERIFY ALL PRODUCT AVAILABILITY, DIMENSIONS, SITE CONDITIONS, AND EQUIPMENT REQUIREMENTS BEFORE COMMENCING ANY WORK. ALL DIMENSIONS AND CONDITIONS MUST BE VERIFIED IN THE FIELD. ANY DISCREPANCIES AND OMISSIONS SHALL BE BROUGHT TO THE ATTENTION OF THE ENGINEER BEFORE PROCEEDING WITH THE AFFECTED PART OF THE WORK.
- THE STRUCTURE IS DESIGNED TO BE SELF SUPPORTING AND STABLE AFTER THE BUILDING IS COMPLETE. IT IS THE CONTRACTOR'S RESPONSIBILITY TO DETERMINE ERECTION PROCEDURES AND SEQUENCE TO ENSURE SAFETY OF THE BUILDING AND ITS COMPONENTS DURING ERECTION. THIS INCLUDES THE ADDITION OF NECESSARY SHORING, SHEETING, TEMPORARY BRACING, GUY'S, OR TIE-DOWNS.
- DESIGN LOADS  
THE STRUCTURAL SYSTEM FOR THIS BUILDING HAS BEEN DESIGNED IN ACCORDANCE WITH SECTION 1609 OF THE 2023 FLORIDA BUILDING CODE, RESIDENTIAL.
- THE MANUFACTURER'S DATA SHEET AND THE STATE (DBPR) INSIGNIA SHALL BE PERMANENTLY MOUNTED TO OR ABOUT THE ELECTRICAL PANEL.
- THIS STRUCTURE HAS BEEN DESIGNED FOR ERECTION OR INSTALLATION ON A SITE BUILT PERMANENT FOUNDATION AND IS NOT DESIGNED TO BE MOVED ONCE SO ERRECTED OR INSTALLED. FOUNDATION SHALL ONLY BE APPROVED BY THE LOCAL BUILDING OFFICIAL.
- ALL SITE RELATED WORK SUCH AS, BUT NOT LIMITED TO, FOUNDATION, TIE DOWN AND ELECTRICAL SERVICE SHALL BE BY OTHERS AND AS PER THE AHJ. NO ELECTRICAL, PLUMBING OR HVAC WORK IS INCLUDED IN THIS SHELL DESIGN
- SITE ENVIRONMENTAL STUDIES, IF REQUIRED, ARE TO BE PERFORMED BY OTHERS.
- PRODUCT/MATERIAL SUBSTITUTION IS PERMITTED IF THE SUBSTITUTE IS EQUAL OR GREATER THAN THE SPECIFIED PRODUCT. TESTING DATA AND/OR VERIFICATION IS THE RESPONSIBILITY OF THE CONTRACTOR.
- ALL REQUIRED PRODUCTS SHALL MEET FLORIDA PRODUCT APPROVAL RULE 61G20-3.006 (FAC)
- ALL DIMENSIONS AND CONDITIONS MUST BE VERIFIED IN THE FIELD. DO NOT SCALE THE DRAWINGS. FOLLOW WRITTEN DIMENSIONS ONLY. ANY DISCREPANCIES SHALL BE BROUGHT TO THE ATTENTION OF THE ENGINEER PRIOR TO PROCEEDING WITH THE AFFECTED PART OF THE WORK.
- THIS BUILDING IS SUBJECT TO REVIEW AND APPROVAL OF THE FIRE INSPECTOR ON SITE WITH COMPLIANCE WITH CH. 633 FIRE SAFETY CODE.
- ITEMS TO BE SITE INSTALLED AND SUBJECT TO LOCAL CODE REVIEW AND COMPLIANCE.

### DESIGN CRITERIA:

DESIGN CONFORMS W/2023 FLORIDA BUILDING CODE, BUILDING, 8th EDITION.  
DESIGNED FOR: 150 MPH 3 SECOND GUST WIND FORCES PER ASCE-7-10 MINIMUM  
DESIGNED FOR: Vwsd 116 MPH WIND NOMINAL DESIGN FORCES  
DESIGN LOADS FOR BUILDING AND OTHER STRUCTURES.  
EXPOSURE CATEGORY - B  
RISK CATEGORY - II  
TYPE III-B CONSTRUCTION  
INTERNAL PRESSURE COEFFICIENT = ±0.18  
TYPE OF OCCUPANCY = U: STORAGE  
OCCUPANT LOAD PER CHAPTER 10: MEANS OF EGRESS  
STORAGE: 300SF/OCCUPANT = 300SF / 300 = 1 OCCUPANTS

ROOF:  
TC LL = 20PSF  
TC DL = 10PSF  
BC LL = 0  
BC DL = 10PSF

COMPONENTS AND CLADDING TO BE INSTALLED PER MANUFACTURERS SPECS  
W/ D.W.P. POS/NEG 30 PSF, CHAPTER 30 COMPONENTS/CLADDING (C&C)

ALL PRESSURE TREATED LUMBER SHALL BE AS FOLLOWS:  
RETENTION (LBS/CU. FT.)      USES/EXPOSURES:  
.25      ABOVE GROUND  
.40      GROUND CONTACT  
         FRESH WATER  
.50      WOOD FOUNDATION  
2.5      SALT WATER

CONCRETE TO BE MIN. 1000psi. REBAR = 40,000 PSI

### CODES:

2023 FLORIDA BUILDING CODE, 8th EDITION - BUILDING  
2023 FLORIDA BUILDING CODE, 8th EDITION - RESIDENTIAL  
2023 FLORIDA FIRE PREVENTION CODE, 8th EDITION



### PROJECT DESCRIPTION:

NEW STORAGE SHED ADDITION IS A NEW CONSTRUCTION OF A BACKYARD STORAGE STRUCTURE. THE SHED WILL HOUSE AND STORE EQUIPMENT. THE BUILDING IS 7' TALL WITH A SLAB, AND IS CLASSIFIED AS ADDITION. THE EXTERIOR WALLS ARE LOAD BEARING WOOD WITH A ONLY STRUCTURE WITH CONCRETE FLOOR. THE ROOF AND FOUNDATION WILL BE TO CODE. THIS BUILDING WILL COMPLY WITH FLORIDA BUILDING CODE REQUIREMENTS.

### INDEX OF DRAWINGS

#### PLAN SHEETS

- G-1 COVER SHEET-GENERAL-NOTES
- G-2 PROJECT INFORMATION
- A-1 FLOOR PLAN-ELEVATIONS-SECTION
- A-3 FRAMING PLAN-ELEVATIONS-DETAILS
- A-4 BUILDING SECTION-FOOTER DETAILS
- A-5 ROOF PLAN-FRAMING-DETAILS
- A-6 FOUNDATION PLAN-SECTION-DETAILS

### CONTACT:

#### GENERAL CONTRACTOR:

7747 NATURE TRAIL  
LAKELAND, FLORIDA 33803  
P: 863-602-4368

#### ENGINEER OF RECORD:

ROBERT T. HAUG, P.E.  
2320 E. EDGEWOOD DRIVE  
LAKELAND, FLORIDA 33803  
PHONE: 863-687-4225  
FL REG NO. 24575

#### DESIGN COMPANY:

Concept Architectural Designs  
PO Box 280342  
Memphis, Tennessee 38168  
P: 901-654-7561

#### PROJECT No: 060225.003

OWNER INFORMATION  
7747 NATURE TRAIL  
LAKELAND, FLORIDA 33803  
P: 863-602-4368

### PROJECT INFORMATION

#### SYMBOLS LEGEND:

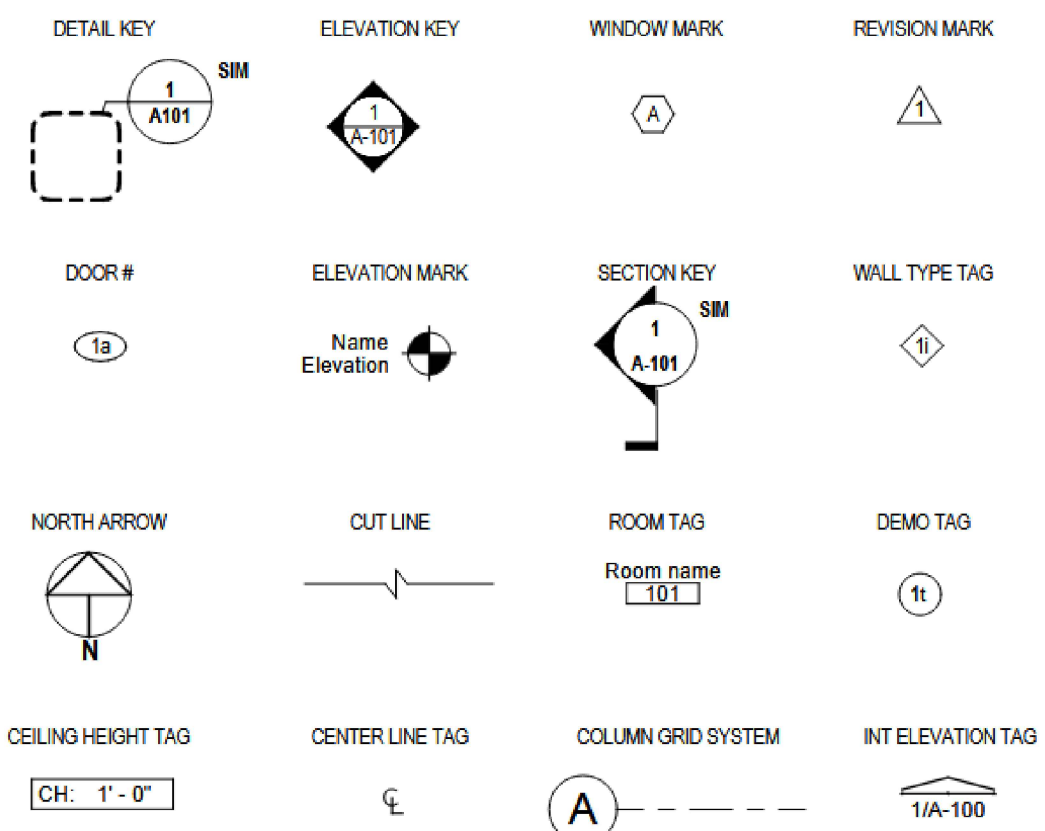

DRAWING TITLE  
**1 View Name**  
1/8" = 1'-0"

### VICINITY MAP:

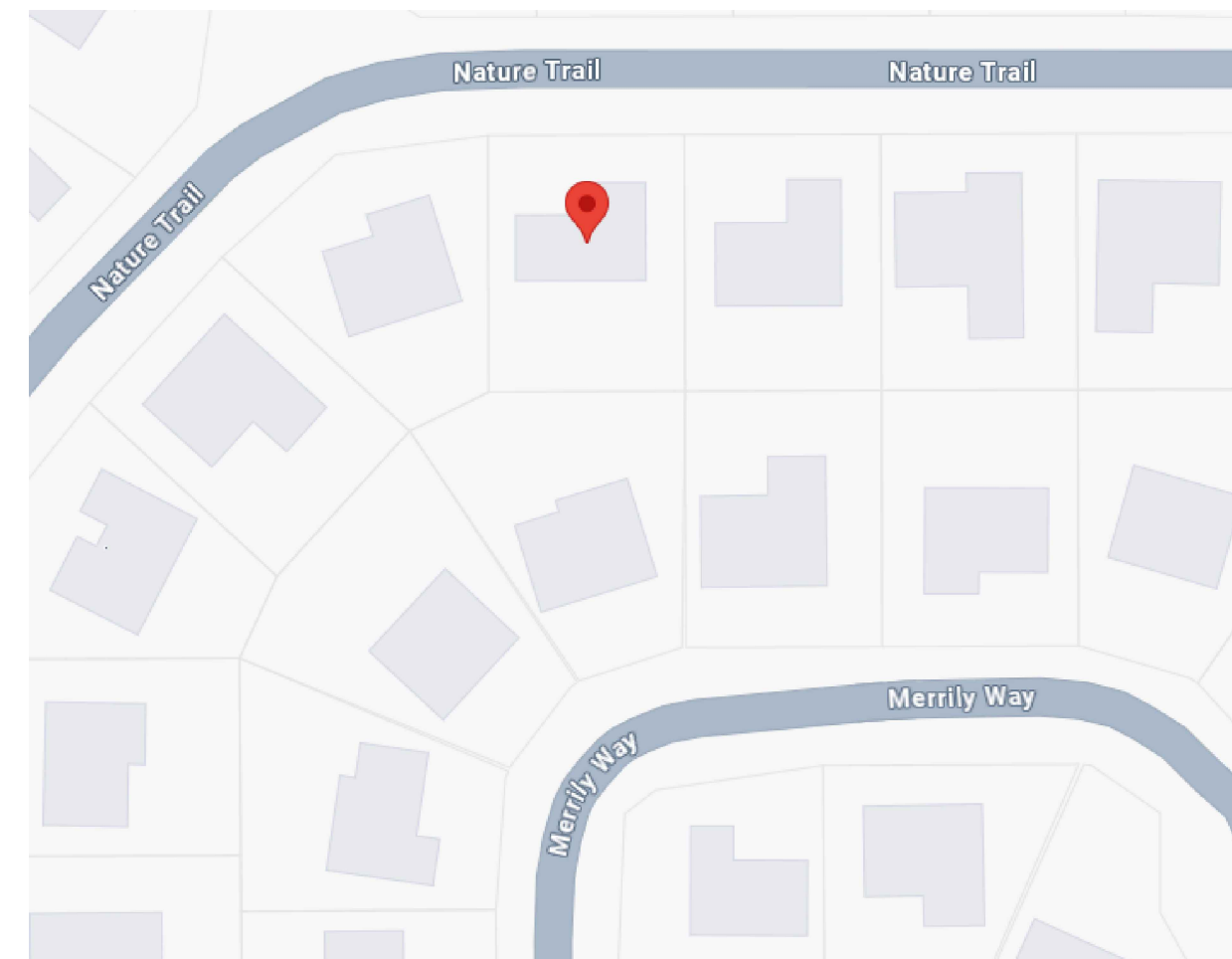

### BUILDING NOTES

- THESE STRUCTURAL DRAWINGS SHALL BE USED FOR THE CONSTRUCTION OF THE SHOWN STORAGE BUILDING. IN THE EVENT OF DIMENSIONAL DISCREPANCY, NOTIFY THE ENGINEER FOR RESOLUTION OF CONFLICT. ANY DEVIATION FROM THESE DRAWINGS MUST BE APPROVED BY THE ENGINEER.
- THIS IS TO CERTIFY THAT THE WOOD FRAME STORAGE BUILDING AS SHOWN ON THESE DRAWINGS HAS BEEN DESIGNED IN ACCORDANCE WITH THE 2023 FLORIDA BUILDING CODE, RESIDENTIAL WITH ALL REVISIONS TO ASCE 7-22 FOR UP TO 150 MPH WIND VELOCITY.
- MATERIALS.  
ALL VERTICAL LUMBER TO BE NO 2 GRADE SPF OR EQUIVALENT. ALL HORIZONTAL FLOOR FRAMING TO BE NO 2 GRADE SYP. ALL PLYWOOD/PLYWOOD GUSSETS SHALL CONFORM TO APA PDS-04. ALL CONNECTORS/FASTENERS (SIMPSON STRONG TIE OR APPROVED) APPLICABLE CODES, TO ASSURE SUPPORT.  
\* NO 2 GRADE SPF LUMBER OR EQUIVALENT IS APPLICABLE UP TO 155MPH SPEED.
- DIMENSIONS LABELED BY LETTERS VARY BY MODEL AND SIZE OF BUILDING AND SHALL BE OBTAINED FROM THE PROVIDED SCHEDULES.
- NON-STRUCTURAL DETAILS AND ITEMS MAY BE CHANGED AT OWNERS DISCRETION.
- ALL FASTENERS AND CONNECTORS IN CONTACT WITH PRESSURE TREATED WOOD SHALL BE HOT DIP GALVANIZED (G 185) OR STAINLESS STEEL. ALL LUMBER IN CONTACT WITH THE EARTH SHALL BE PRESSURE TREATED WITH PRESERVATIVE. EXTERIOR NON-TREATED WOOD SIDING SHALL NOT BE LESS THAN 12" FROM EXPOSED EARTH.
- ALL SITE WORK, INCLUDING BUT NOT LIMITED TO, CONCRETE/ANCHORING/ELECTRICAL CONNECTIONS, SHALL BE BY OTHERS.

### SIMPSON CONNECTOR NOTES

- SIMPSON CONNECTIONS SPECIFIED ARE DESIGNED AND MANUFACTURED FOR THE PURPOSES SHOWN, AND SHOULD NOT BE USED WITH OTHER CONNECTORS NOT APPROVED BY THE DESIGN ENGINEER. MODIFICATIONS TO PRODUCTS OR CHANGES IN INSTALLATION PROCEDURES SHOULD NOT BE MADE WITHOUT THE APPROVAL OF THE ENGINEER. THE PERFORMANCE OF SUCH MODIFIED PRODUCTS OR ALTERED INSTALLATION PROCEDURES IS THE SOLE RESPONSIBILITY OF THE OWNER/CONTRACTOR.
  - SUBSTITUTIONS FOR SIMPSON STRONG-TIE CO. INC.'S PRODUCTS SHALL BE APPROVED IF EQUAL AND APPROVED IN WRITING BY THE ENGINEER.
- INSTRUCTIONS FOR THE INSTALLER:
- ALL SPECIFIED FASTENERS MUST BE INSTALLED ACCORDING TO THE INSTRUCTIONS IN THE SIMPSON CATALOG. INCORRECT FASTENER QUANTITY, SIZE, TYPE, MATERIAL, OR FINISH MAY CAUSE THE CONNECTION TO FAIL. 16D FASTENERS ARE COMMON NAILS (18GA X 3-1/2") UNLESS OTHERWISE SPECIFIED.
  - BOLT HOLES SHALL BE A MINIMUM OF 1/32" AND A MAXIMUM OF 1/16" LARGER THAN THE BOLT DIAMETER.
  - INSTALL ALL SPECIFIED FASTENERS BEFORE LOADING THE CONNECTION.
  - PNEUMATIC OR POWDER-ACTUATED FASTENERS MAY DEFLECT AND INJURE THE OPERATOR OR OTHERS. NAIL GUNS MAY BE USED TO INSTALL CONNECTORS, PROVIDED THE CORRECT QUANTITY AND TYPE OF NAILS ARE PROPERLY INSTALLED IN THE NAIL HOLES. GUNS WITH NAIL HOLE-LOCATING MECHANISMS SHOULD BE USED. FOLLOW THE MANUFACTURER'S INSTRUCTIONS AND USE THE APPROPRIATE SAFETY EQUIPMENT.

### STRUCTURAL NOTES

STRUCTURAL DESIGN IS IN ACCORDANCE WITH FLORIDA BUILDING CODE, RESIDENTIAL 2023 8TH EDITION

### CODE NOTES

Code Version	2023 FBC Residential, 8th Ed.
Building Type	STORAGE, MEETS R3 STANDARDS
Construction Type	VB
Fire Protection	N/A
Fire Suppression System	N/A
Occupancy	UTILITY
Allowable Stories	1
Wind Velocity	150 mph*
Fire Rating Exterior Walls	N/A
Max Floor Load	Live 120 psf, Dead 10 psf
Roof Load	Live 20 psf, Dead 8 psf
"R" Ratings	N/A
Modules per Building	1
Square Footage	Max 144 sqft

### WIND DESIGN DATA:

WIND LOAD: ULTIMATE WIND DESIGN SPEED, 3 SEC. GUST = 150MPH  
BUILDING RISK CATEGORY = I: STORAGE  
OCCUPANCY CATEGORY: U  
RISK CATEGORY: II  
WIND INTERIOR PRESSURE COEF: .18  
EXPOSURE B  
SURFACE ROUGHNESS: B



concept architectural designs  
PO Box 280342  
Memphis, Tennessee 38168  
P: 901-654-7561  
https://www.conceptads.com  
BUILDING DESIGN

ENGINEER OF RECORD:  
**ROBERT T. HAUG P.E.**  
CONSULTING ENGINEER  
FL REG NO. 24575  
2320 E. EDGEWOOD DRIVE LAKELAND,  
FLORIDA 33803 PH: 863-687-4225

THIS ITEM HAS BEEN ELECTRONICALLY SIGNED AND SEALED BY ROBERT T. HAUG P.E. ON THE DATE AND TIME STAMP SHOWN USING A DIGITAL SIGNATURE. PRINTED COPIES OF THIS DOCUMENT ARE NOT CONSIDERED SIGNED AND SEALED. SIGNATURE MUST BE VERIFIED BY A 3rd PARTY CERTIFICATE AUTHORITY ON ANY ELECTRONIC COPY.

**NEW STORAGE SHED ADDITION**  
**7747 NATURE TRAIL**  
**LAKELAND, FLORIDA 33803**

2025 Concept Architectural Designs. This Drawing is the Exclusive Property of Concept Architectural Designs And May Not Be Reproduced Or Used Without Their Authorization And Written Permission.

RELEASED FOR USE NOT FOR CONSTRUCTION

NOTE: THIS SET OF DRAWINGS DEFINE PROJECT SCOPE AND CONTRACT REQUIREMENTS. DO NOT SEPARATE THIS SET OF DRAWINGS INTO INDIVIDUAL SHEETS

PROJECT No: **060225.003**

DATE: **June 02, 2025**

COVER SHEET

SHEET NO:  
**G-1**