

## Proposers Incorporation Information

(Submittal Page)

The following section should be completed by all bidders and submitted with their bid submittal:

Company Name: The Lunz Group

DBA/Fictitious Name (if applicable): \_\_\_\_\_

TIN #: 87-4155040

Address: 58 Lake Morton Drive

City: Lakeland

State: FL

Zip Code: 33801

County: Polk

Note: Company name must match legal name assigned to the TIN number. A current W9 should be submitted with your bid submittal.

Contact Person: Bradley Lunz

Phone Number: 863-682-1882

Cell Phone Number: 863-682-1882

Email Address: marketing@lunz.com

Type of Organization (select one type)

- ☐ Sole Proprietorship
- ☐ Partnership
- ☐ Non-Profit
- ☐ Sub Chapter
- ☐ Joint Venture
- ☐ Corporation
- ☒ LLC
- ☐ LLP
- ☐ Publicly Traded
- ☐ Employee Owned

State of Incorporation: Florida

The Successful vendor must complete and submit this form prior to award. The Successful vendor must invoice using the company name listed above.

PREPARED FOR  
**POLK COUNTY SHERIFF'S OFFICE +  
POLK COUNTY FACILITIES  
MANAGEMENT**

ARCHITECTURAL & ENGINEERING SERVICES FOR THE SHERIFF'S OFFICE - POLK  
COUNTY JOINT-USE WAREHOUSE & FACILITIES MANAGEMENT  
ADMINISTRATION BUILDING

RFQ 24-643

PREPARED BY

**THE  
LUNZ  
GROUP**

Architecture | Interior Design

# COVER LETTER

November 19, 2024  
Polk County Procurement Division  
330 West Church Street, Room 150  
Bartow, Florida 33830

RE: RFP 24-643 Architectural & Engineering Services for the Sheriff's Office - Polk County Joint-use Warehouse & Facilities Management Administration Building

Dear Selection Committee,

The Lunz Group is excited to collaborate with Polk County to provide Architectural and Engineering Services for RFP 24-643 Architectural & Engineering Services for the Sheriff's Office - Polk County Joint-use Warehouse & Facilities Management Administration Building. In understanding how we can best serve Polk County, we have assembled a team that has the knowledge and expertise.

**WHO WE ARE |** The Lunz Group is a full-service architectural firm. We have a vested interest in building a better community starting with the built environment. We are passionate about seeing our community flourish, and we hope to provide you with design solutions that best fit your needs. We continue to grow and innovate by creating a distinct, client-centered experience, focused on delivering the best of our institution's talents, solutions and processes. Our firm is comprised of more than 24 experienced personnel, including licensed architects, project managers, designers, and an administrative team. Polk County has been our home base for more than 37 years, and we look forward to continuing to serve our community.

**OUR PHILOSOPHY |** At The Lunz Group, we approach every project the same way: by listening. We listen to your vision, goals, and challenges. We ask the pivotal questions to ensure your investment meets you at a higher value. We recognize values beyond the mere built environment, emphasizing the importance of your vision. Prior to the design process, we work closely with you to identify and address any anticipated or existing obstacles. The Lunz Group is comprised of design thinkers; we integrate our passion and technical expertise in everything we do. Our team focuses on innovative problem-solving by leveraging technology and providing a human-centered design approach. We provide full-service design, documentation, and quality control services driven by our unwavering commitment to our work and our clients. Our success is defined by exceeding our client's expectations, delivering designs that create solutions and buildings that last beyond our lifetime.

**OUR COMMITMENT TO POLK COUNTY |** Through our method of approach and best practices, The Lunz Group is positively committed to perform the services on a consistent and timely basis. Communication and Collaboration are part of our core values; without these elements, no project can be successful. We believe our team is not solely us - it also includes Polk County staff, key stakeholders, and our community. Communication and collaboration in the early phases of projects is critical when needing to stay on budget and on schedule. We have intentionally crafted a team of experts that are familiar with Polk County and have similar project experience, including: **Subject Matter Expert, Johnnie Lohrum, TLC Engineering, Kimley-Horn & Associates, and MES Group Inc.**

We do not foresee any potential conflicts of interest for these projects. We acknowledge Addenda 1, 2, and 3. Thank you for considering The Lunz Group, and we are committed to perform the specified work and look forward to the opportunity to be a part of your team once again.

Sincerely,



Bradley T. Lunz, AIA, NCARB  
President & CEO, The Lunz Group

Phone 863.682.1882 | Email [marketing@lunz.com](mailto:marketing@lunz.com) | 58 Lake Morton Dr, Lakeland, FL 33801 | [lunz.com](http://lunz.com) | LIC: AR94778



## VISION

Cultivating our communities.

## MISSION

Building relationships through design.

### TABLE OF CONTENTS

05	TAB 1	EXECUTIVE SUMMARY
09	TAB 2	APPROACH TO PROJECT
14	TAB 3	EXPERIENCE, EXPERTISE, PERSONNEL & TECHNICAL RESOURCES
35	TAB 4	IS THE FIRM A "POLK COUNTY ENTITY"?
37	TAB 5	IS THE FIRM A "CERTIFIED WOMAN OR MINORITY BUSINESS ENTERPRISE"?
39	TAB 6	INTERACTION WITH COUNTY AND REGULATORY AGENCY STAFF
41	TAB 7	TIMELY COMPLETION OF PROJECTS
43	TAB 8	SURVEYS OF PAST PERFORMANCE
44	TAB 9	ADDENDA ACKNOWLEDGEMENTS



The background image is a photograph of a modern office interior, overlaid with a semi-transparent blue filter. The office features a curved ceiling with recessed lighting, white walls, and a series of cubicles or workstations. A person is walking in the background, and there are shelves and cabinets visible. The text 'TAB 1' is prominently displayed in large, bold, white letters, followed by 'EXECUTIVE SUMMARY' in smaller, white, all-caps letters. A thin white vertical line is positioned to the left of the text.

# TAB 1

## EXECUTIVE SUMMARY

# EXECUTIVE SUMMARY

## WE ARE THE LUNZ GROUP.

**The Lunz Group** is a client-oriented, Florida based, award-winning architectural firm. At The Lunz Group, we approach every design as a collaborative experience where we listen to your vision and project goals. Our team of architects, designers and planners are in sync with the evolving demands of a modern civic work environment where municipalities want to develop state-of-the-art facilities while still meeting budgetary requirements.

Our municipal team has experience dealing with a multitude of public and civic projects, from fire and police stations, to administrative facilities, parks and recreation and more. Our designers are experienced with nearly every project type including interior/exterior renovations, code compliance, new construction, building assessments, studies, visualizations, and rehabilitation needs that enhance the quality of life for the community. The Lunz Group has partnered with Polk County and Polk County Sheriff's Office on various projects throughout the last three decades, including projects such as fire station, administrative department facilities, training centers, and more.

# 160<sup>+</sup>

PROJECTS  
COMPLETED IN  
POLK COUNTY

# 37

YEARS IN  
BUSINESS

# 90%

OF OUR SERVICES  
PROVIDED TO  
REPEAT CLIENTS



## OUR PROFESSIONAL SERVICES

- ARCHITECTURAL DESIGN
- SCHEMATIC DESIGN
- BID & CONTRACT DOCUMENTS
- MASTER PLANNING
- SPACE PLANNING
- ANIMATION
- SITE ANALYSIS
- INSPECTIONS & PERMITTING
- PROGRAMMING
- PROGRAM MANAGEMENT
- CONSTRUCTION ADMINISTRATION
- VALUE ENGINEERING
- HISTORIC PRESERVATION
- GRAPHICS
- BUILDING COMMISSIONING
- INTERIOR DESIGN
- VISUALIZATION



# EXECUTIVE SUMMARY

## FIRM OVERVIEW

# THE LUNZ GROUP.

### PRIMARY CONTACT

Bradley T. Lunz, AIA, NCARB  
President & CEO, The Lunz Group  
58 Lake Morton Drive  
Lakeland, FL 33801  
marketing@lunz.com  
863-682-1882  
www.lunz.com

### OFFICE LOCATIONS

Headquarters/Proposing Office - Lakeland, FL  
58 Lake Morton Drive, Lakeland, FL 33801

Branch Office - Celebration, FL  
615 Celebration Avenue, Kissimmee, FL 34747

### PERSONNEL RESOURCES

23 total employees, of which includes:

- Five (5) Licensed Architects
- Nine (9) Designers
- Two (2) Project Managers
- Five (5) Administrative Staff
- One (1) Green Globes Professional
- One (1) Registered Residential Contractor

### FIRM INFORMATION

The Lunz Group LLC

Parent Company | S Corp.  
Little Blue Heron Holdings, Inc.

Incorporated in Florida, 1987 | 37 Years in Business

## State of Florida Department of State

I certify from the records of this office that THE LUNZ GROUP, LLC is a limited liability company organized under the laws of the State of Florida, filed on January 12, 2022, effective November 5, 1987.

The document number of this limited liability company is L22000015399.

I further certify that said limited liability company has paid all fees due this office through December 31, 2024 and that its status is active.



Given under my hand and the  
Great Seal of the State of Florida  
at Tallahassee, the Capital, this  
the Twenty-first day of October,  
2024

  
Secretary of State

Tracking Number: 8783141720CU

To authenticate this certificate, visit the following site, enter this number, and then follow the instructions displayed.

<https://services.sunbiz.org/Filings/CertificateOfStatus/CertificateAuthentication>

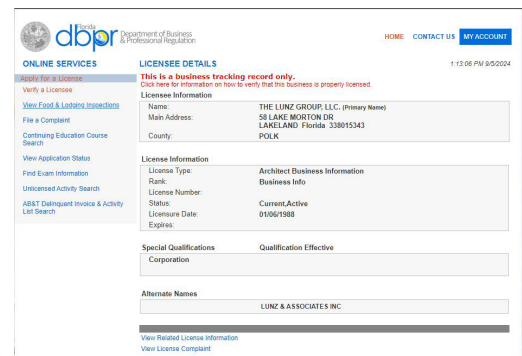

ONLINE SERVICES

Verify a License  
View Exam & Licensure Information  
File a Complaint  
Continuing Education Course Search  
View Application Status  
Find Exam Information  
Unlicensed Activity Search  
ASAT Delinquent Invoice & Activity List Search

LICENSEE DETAILS

This is a business tracking record only. Click here for information on how to verify that the business is properly licensed.

Licensee Information

Name: THE LUNZ GROUP, LLC (Primary Name)  
Main Address: 58 LAKE MORTON DR, LAKELAND, Florida 338015343  
County: POLK

License Information

License Type: Architect Business Information  
Rank: Business Info  
License Number: Current/Active  
Status: 01/06/1987  
Expires: 01/06/1987

Special Qualifications

Qualification Effective: Corporation

Alternate Names

LUNZ & ASSOCIATES INC

View Related License Information  
View License Complaint

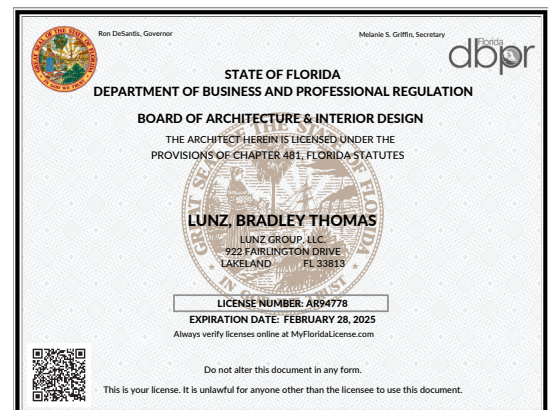

# EXECUTIVE SUMMARY

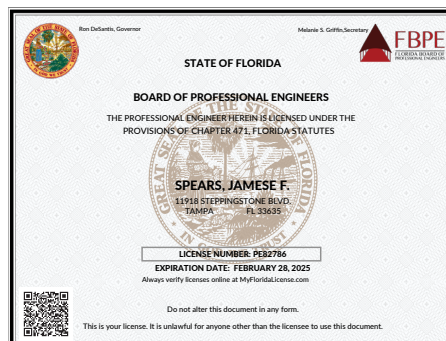
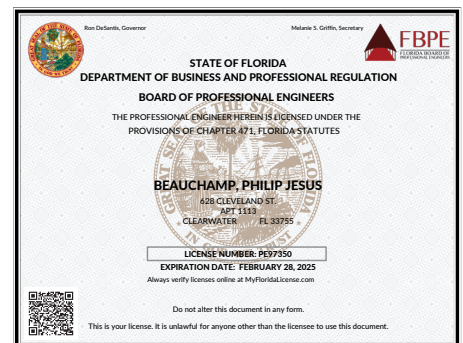
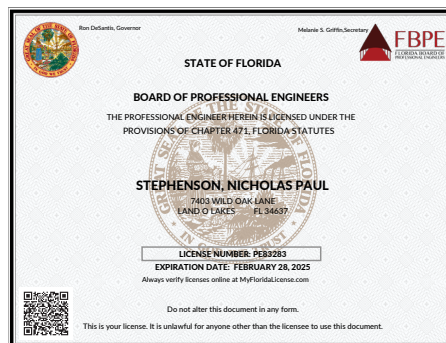
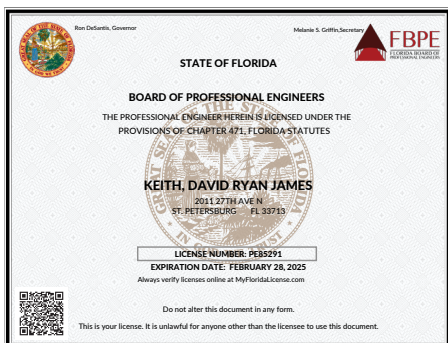
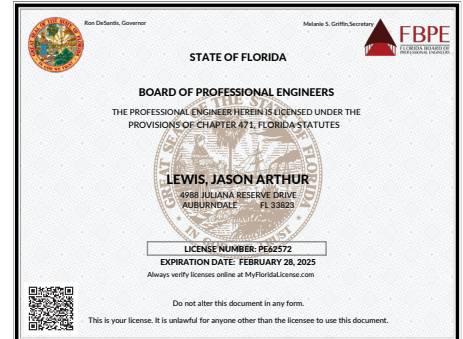
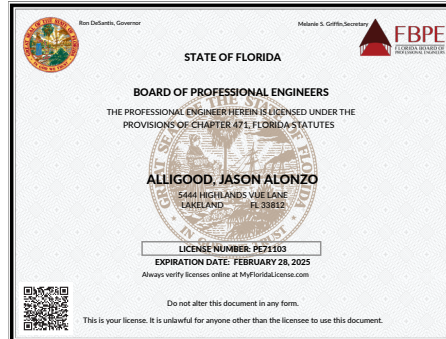
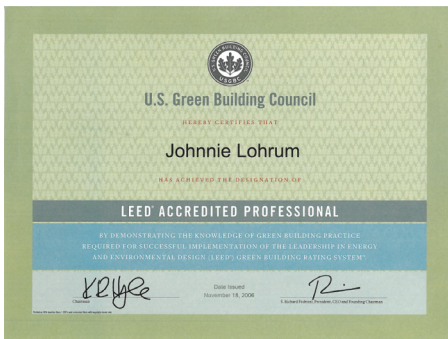
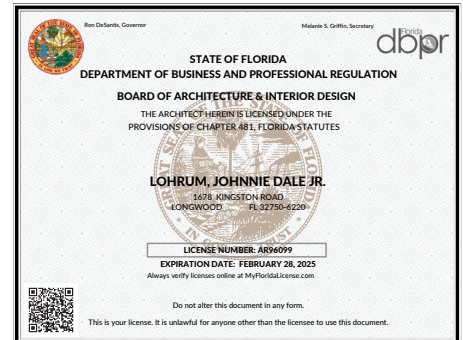
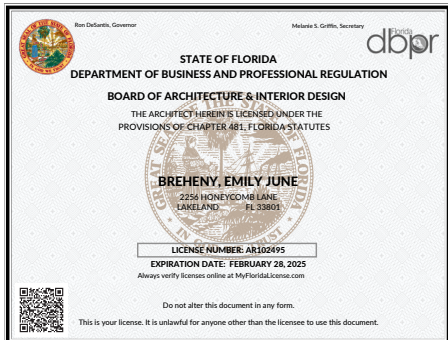
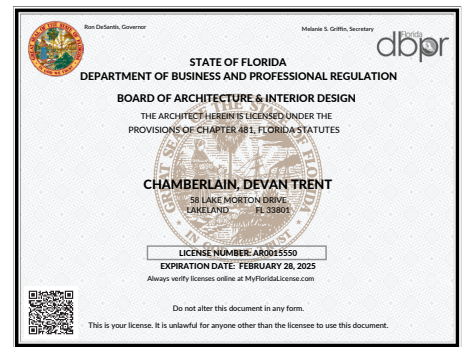





# TAB 2

APPROACH TO PROJECT

# APPROACH TO PROJECT

**PROJECT UNDERSTANDING |** It is our understanding that Polk County is seeking professional architectural and engineering services To design and build a joint-use warehouse and facilities management administration building that will serve Polk County facilities management as well as the Polk County Sheriff's Office. We understand the intent of the project is to design and build a 100,000 square foot warehouse with 15,000 square feet of office space located within the warehouse. 80,000 square feet will be for the Sheriff's property and evidence storage and supply operations, which includes 5,000 square feet of office space. 10,000 square feet will be for Polk County's emergency supply storage, and finally, another 10,000 square feet will be for facilities management and administrative offices. The construction cost is estimated at \$18M, with the structure system desired being tilt-wall concrete construction. We understand the County owns two sites in Bartow that can be utilized for this project, with preference towards the first site that includes utilities and convenient access points.

**OUR APPROACH |** The Lunz Group and it's consultants are very familiar with Polk County's processes, project approach, and best practices. Our longstanding relationship with the Polk County team and range of projects positions us to be the top choice for this new facility. We intentionally selected our team of qualified, experienced subconsultants to form a strong project team. Our approach begins with conducting thorough due diligence in the pre-design phase, which entails an in-depth code and site investigation to ensure a solid foundation for the project. Collaboration is one of our core values and a key component of our process. We will engage with all stakeholders during the programming phase to ensure we understand and incorporate their needs for this project. Our BIM management system enables clear and effective communication between our consultants and the Polk County team, ensuring that the documentation remains clear and accurate from Schematic Design (SD) through Construction Documents (CD). Finally, throughout the Construction Administration phase, our experienced team and Project Manager will provide ongoing administration, from pre-bid through to close-out, ensuring that the project is built efficiently and to the highest standards for Polk County.



**SPECIFIC ABILITIES |** Our firm strives to deliver projects on time and on budget to meet the needs of our clients. We understand that timelines for many of our clients are critical and have experience working within time constraints. Senior Project Manager, Gregory Selvidge, will provide team oversight to ensure deadlines are being met through regular check-ins and accountability. We also work with our clients and consultants to set realistic, attainable timelines at the start of each project, to ensure schedule expectations are clear with all parties involved.

The Lunz Group generates a fully detailed fee proposal that identifies the project scope, fee structure, duration, and deliverables

per phase. The fee proposal also identifies all project related consultants, their roles, and responsibilities. We identify what we've heard, list of included and excluded scope items, and more, as a means for the client to fully understand what we believe is captured in the project.

The Project Manager conducts a weekly walk-through of tasks to be completed for the following week to ensure tasks are being managed and completed on schedule. The project schedule identifies all critical milestone packages, internal QA/QC checkpoints, and Owner review periods to ensure schedule compliance. Throughout the life cycle of the project, we will utilize our internal QA/QC process to limit errors and omissions. This process alerts the team to tasks that are pending or falling behind schedule so that steps can be planned to bring those tasks back to schedule compliance. All project related design and Owner-Architect-Contractor meetings are led by The Lunz Group team. We'll author and distribute any necessary meeting minutes and action items to the entire team. Additionally, our team also utilizes a project-based ERP software that builds a Work Breakdown Structure to identify internal staffing resources required to deliver the project efficiently, on time and on budget.



# APPROACH TO PROJECT

**TECHNOLOGIES** | Our firm has been around for almost 37 years, and within those three decades, we have constantly adapted to changes in technology and best practices. As part of The Lunz Group's process, we set time aside to sit with our clients and review our formal proposal face-to-face, to ensure all parties are on the same page, and that all goals and project vision align with client needs.

Most recently, our firm has been updating our BIM standards to better serve our clients and work with our team of engineers more efficiently. We leverage all aspects of 3D modeling, instead of relying solely on 2D AutoCAD Drafting. Part of updating our BIM Standards includes a BIM Execution Plan we share with our subconsultants prior to onboarding them to the project. This ensures that all parties on the design team are utilizing the same technologies and design standards; this benefits our clients in regard to scheduling and seamless review. With our BIM Standards, we have incorporated clash detection among Architectural, MEP, and Structural drawings in our process. In addition, by utilizing 3D tools and Autodesk Construction Cloud (ACC), our team provides clients with the opportunity to be involved at their own pace. This bridges the gap between Owner and Architect for visual check-ins.

Our in-house visualization team provides larger than life renderings to bring the project from concept to reality. Our visualization team is able to quickly turn around design-focused renderings to ensure we are meeting the aesthetic goals and objectives for the project. Our collective of interdisciplinary artists hold decades of professional experience spanning animation, concepting, visualization and more. Animating previsualized worlds is what we do best, and by doing so, help sell concepts, convey intent, and help create buy-in from key stakeholders and community members.

Additionally, our team utilizes a Matterport Pro3 3D Camera, which allows our team to evaluate existing conditions of buildings. This device produces 3D scans that can be imported directly into Revit and modeled alongside, creating efficiencies for our team and clients. This resource has aided our clients with scheduling and budgeting. Utilizing this technology prior to programming helps our team understand what may be required and discussed prior to any finalized designs or floor plans.

**EVIDENCE PROCESSING** | Building Systems are a key part of the Chain of Custody when evidence is processed and stored. Preservation of evidence is achieved with redundant electrical power from emergency generators to provide proper dehumidification of storage areas and proper refrigeration and monitoring of biologically sensitive evidence. Proper HVAC design also includes proper exhausting of biologic and toxic fumes from both Evidence Storage and the Forensics Laboratory. Survivability of the Polk County Facility is critical to allow all other building systems to function and preserve the Chain of Custody. If the envelope of the secured building is compromised all other systems dedicated to properly store evidence could be damaged and/or lost. In the event of a natural or man-made disaster the essential function of law enforcement includes the evidence processing and storage.

Evidence storage shall be placed adjacent and connected only to Evidence Processing spaces to allow for evidence processing staff to process all evidence securely. Different evidence shall be separated into different rooms with access control to each based on the type of evidence. The following evidence categories include: Cash/Valuables, Narcotics, Weapons, and Bulk Evidence Storage.

**BUILDING SECURITY** | Typically all public safety buildings including Evidence Processing and Storage buildings should have limited points of access, generally a singular public entry and a separate point of staff access into the facility. Entry to the Evidence Processing and Storage building must be controlled with a variety of systems including, CCTV monitoring, electronic locking devices at doors and voice communication (push-to-call) capability. These systems are generally "discrete" in that they are non-obtrusive while providing the necessary security functions. Similarly, all items brought into the building by a visitor can be screened and state of the art technology to accomplish these tasks is readily available. Deliveries of products, supplies and mail pose unique threats to a facility, as recent events have shown. Some entities have elected to locate separate facilities to accommodate these functions in order to protect against total building failure from contaminants such as Anthrax or introduced air borne pathogens. CPTED (Crime Prevention Thru Environmental Design) principles will be utilized throughout the design of the new Evidence Facility.

# APPROACH TO PROJECT

## QUALITY CONTROL & QUALITY ASSURANCE

The Lunz Group relies on our Quality Control & Quality Assurance (QC/QA) plan to assure work plan compliance. Our project quality assurance plan ensures that regular project review meetings occur to update information and verify schedule and budget targets.

**Our quality control structure consists of: Principal in Charge, Project Manager & QA/QC Principal**



The Lunz Group has found that by instilling our three-tier QA/QC process in every project, our team is able to produce accurate and detailed drawings for permit, meaning less back-and-forth with department for approvals and a quicker turn around for construction kick-off. It also allows for us to remain on schedule, even during accelerated schedule projects.

All plans are reviewed at each milestone (30%, 60%, 90% and 100%) by QA/QC principals who are not involved in the project. At the 30% submittal, we confirm our consultant's understanding of scope and budget. As the project progresses, we seek insight from the Polk County team as they determine the adequacy of the work, design, costs and adherence to project criteria.

Regular meetings are held with our consultants to discuss the status of the project. Timeline schedule charts and budget analysis are discussed; near-term deliverables are defined. This process alerts the team to tasks that are pending or falling behind schedule so that steps can be planned to bring those tasks back to schedule compliance. During all phases of the project, our team tracks budget adherence and assures quality, to ensure Polk County is receiving exceptional services.



# APPROACH TO PROJECT

## ANTICIPATED DESIGN SCHEDULE

Each project is unique in its’ needs, budget, and timeliness. The Lunz Group is dedicated to getting each project completed in a time that is practical and fits your needs, without sacrificing quality. We will work with our design team and the Polk County team to deliver a comprehensive schedule for the Joint-Use Warehouse & Facilities Management Administration Building.

Our firm strives to deliver projects on-time and on-budget to meet the needs of our clients. We understand that timelines for many of our clients are critical and have experience working within time constraints. **Senior Project Manager, Gregory Selvidge**, will provide team oversight to ensure deadlines are being met through regular check-ins and accountability. We also work with our clients and consultants to set realistic, attainable timelines at the start of each project, to ensure schedule expectations are clear with all parties involved.

At this time, we anticipate the following tentative schedule:

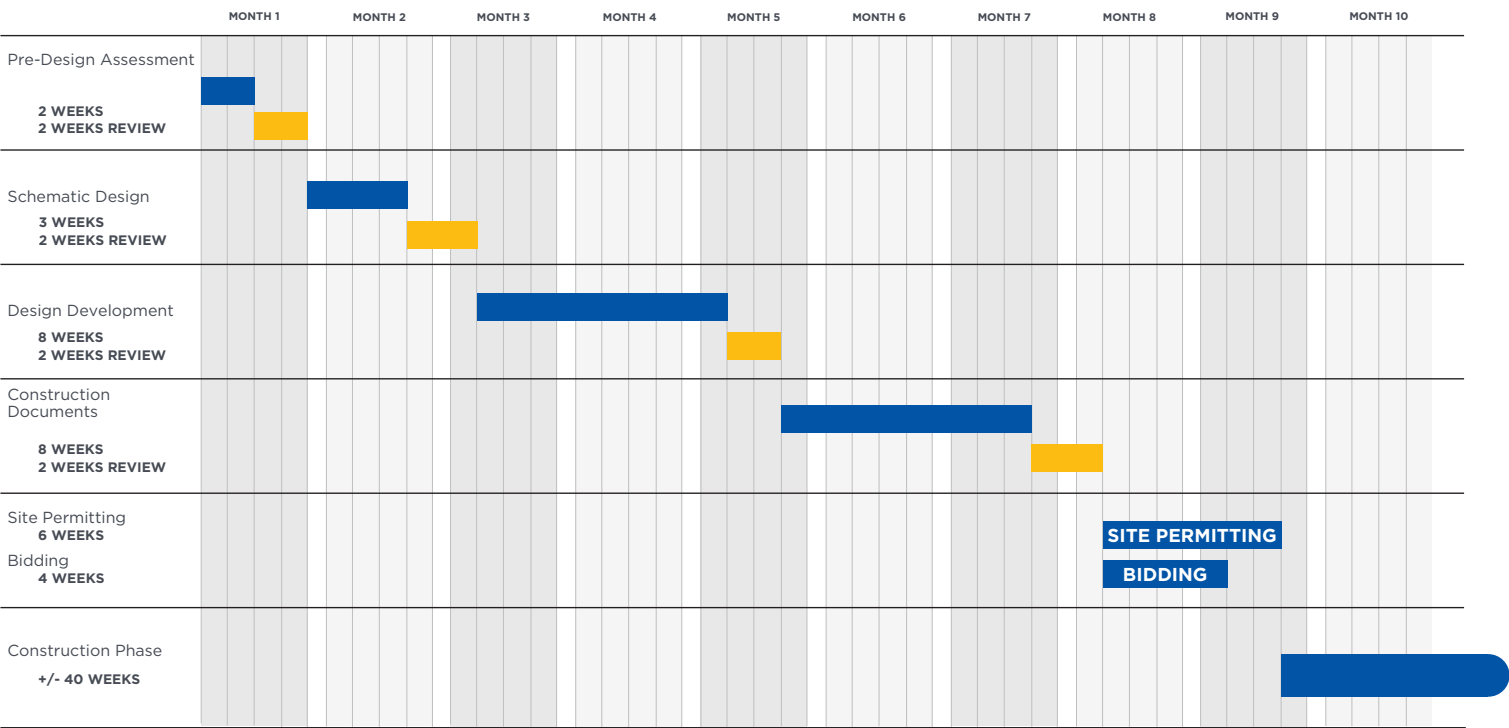

Estimated Project Duration:

**+/- 73 WEEKS | +/- 17 MONTHS**

\*Schedules above are estimated and based on current projects; this is subject to change. Phases can occur simultaneously to accelerate schedules or further collaboration with multiple departments as needed.



# TAB 3

EXPERIENCE, EXPERTISE, PERSONNEL  
& TECHNICAL RESOURCES



EXPERIENCE, EXPERTISE, **PERSONNEL & TECHNICAL RESOURCES**

## POLK COUNTY SHERIFF'S RIDGE DISTRICT STATION AT POINCIANA

POINCIANA, FL



**SIZE:** 21,000 SF | **COMPLETED:** IN PROGRESS | **COST:** EST. \$9M

**PROJECT REPRESENTATIVE:** Andria McDonald, Executive Director | 1891 Jim Keene Blvd., Winter Haven, FL 33880 | 863.298.6604 | amcdonald@polksheriff.org

### PROJECT DESCRIPTION

The Lunz Group is currently designing the Sheriff's East District Command Center. Services are to include, but are not limited to; all required permitting, design and construction for a new building, site development, storm water systems, utility service engineering, accompanying access entrance drives, surface parking areas, site lighting, general fencing, and landscaping.

The Sheriff's East District Command Center will be constructed on County owned property located in the East area of Polk County. The primary intent of the project is to design, permit and construct an approximate +/- 21,000 square foot single story building providing for new administration offices, meeting rooms, breakroom, restrooms and sallyport. The project will utilize a reuse of the current Northridge District Station completed in 2009 by The Lunz Group. This project is hurricane hardened, is funded through a Federal Grant, and is to be constructed through the Design-Bid-Build construction method.

**KEY PERSONNEL:** Bradley T. Lunz, Principal In Charge; Gregory Selvidge, Senior Project Manager; Emily Breheny, Project Manager; Trent Chamberlain, Senior Project Architect/QA

**CONSULTANTS:** MES Group Inc.

**BUDGET + SCHEDULE VARIATIONS:** N/A

**FIRM RESPONSIBILITY:** Architect of Record

EXPERIENCE, EXPERTISE, **PERSONNEL & TECHNICAL RESOURCES**

## **POLK COUNTY SHERIFF'S BURNHAM-MCCALL TRAINING CENTER**

**BARTOW, FL**



**SIZE:** 48,000 SF | **START DATE:** 2021 | **COMPLETION DATE:** 2024

**ORIGINAL BUDGET:** \$6.8M | **FINAL COST:** \$6.8M

**PROJECT REPRESENTATIVE:** Andria McDonald, Executive Director | 1891 Jim Keene Blvd., Winter Haven, FL 33880 | 863.298.6604 | amcdonald@polksheriff.org

### **PROJECT DESCRIPTION**

The Lunz Group worked with the Polk County Sheriff's Office for the Architectural and Engineering Services for the new Burnham-McCall Training Center Facility. The scope included the removal and replacement of the existing building structures with a new administration and classroom single story building structure in conjunction with the training range facilities that remained in place. The project consisted of two distinct work phases. The first phase included the construction of an approximate 22,000 SF pre-engineered metal building (with insulated metal panels), various site improvements inclusive of required storm water pond construction, new utility connections, drives, landscaping and parking areas. The second phase incorporated the removal and disposal of the existing modular building structures and site cleanup, grading and sodding. Designing a facility that met site constraints and provided adequate parking was a great accomplishment for our team. Unique site challenges were faced during design, such as; the drive track's proximity to wetlands, and a TECO easement near the property line. Our team worked closely with Polk County to determine the best course of action and provided solutions. The Burnham-McCall Training Center withstood three major hurricanes prior to the grand opening, with no issues or damages reported.

**KEY PERSONNEL:** Bradley T. Lunz, Principal In Charge; Gregory Selvidge, Senior Project Manager; Emily Breheny, Project Manager; Trent Chamberlain, Senior Project Architect/QA

**CONSULTANTS:** TLC Engineering, MES Group Inc.

**BUDGET + SCHEDULE VARIATIONS:** N/A, on schedule and on budget.

**FIRM RESPONSIBILITY:** Architect of Record



EXPERIENCE, EXPERTISE, **PERSONNEL & TECHNICAL RESOURCES**

## POLK COUNTY ROADS & DRAINAGE OFFICE ANNEX

WINTER HAVEN, FL



**SIZE:** 16,907 SF | **START DATE:** 2018 | **COMPLETION DATE:** 2022

**ORIGINAL BUDGET:** \$3.5M | **FINAL COST:** \$3.5M

**PROJECT REPRESENTATIVE:** Steve McMillan, Polk County Architectural Services Manager  
863.534.5511 | stevemcmillan@polk-county.net

### PROJECT DESCRIPTION

Our team designed a new administration office building and parking lot, connecting to an existing office-warehouse building in a campus style juxtaposition. Services provided included architectural design, mechanical engineering, electrical engineering, plumbing engineering, structural engineering, civil engineering, and landscape architecture. Despite the COVID-19 outbreak during the construction phase, our team managed to complete the project on-schedule and on-budget. We were also required to provide a new wastewater life station, which was not included in the original budget. With value engineering and cooperation with the end-users, we were able to meet the County's budget.

**KEY PERSONNEL:** Bradley T. Lunz, Principal In Charge; Gregory Selvidge, Senior Project Manager; Emily Breheny, Project Architect; Trent Chamberlain, Senior Project Architect/QA

**CONSULTANTS:** MES Group Inc.

**BUDGET + SCHEDULE VARIATIONS:** On schedule, Eight (8) Change Orders totaling \$357,328.83 (Client Savings)

**FIRM RESPONSIBILITY:** Architect of Record



EXPERIENCE, EXPERTISE, **PERSONNEL & TECHNICAL RESOURCES**

## POLK COUNTY UTILITIES OPERATIONS

WINTER HAVEN, FL



SIZE: 48,000 SF | START DATE: 2016 | COMPLETION DATE: 2018

ORIGINAL BUDGET: \$5M | FINAL COST: \$5M

PROJECT REPRESENTATIVE: Steve McMillan, Polk County Architectural Services Manager  
863.534.5511 | stevemcmillan@polk-county.net

### PROJECT DESCRIPTION

The Lunz Group collaborated with Jones Edmunds on this project, serving as the Architect of Record. The initial process included preliminary programming analysis of the site & proposed building typologies to identify space requirements, including square footage and adjacencies. The Lunz Group was awarded the project in 2016 to lead the design process for a new, 48,000 SF operations building with design emphasis placed on the original findings. A 5,000 SF control building was included in this overall design.

The administration building contains office space, warehousing, and maintenance accommodations, eliminating unneeded areas from the building footprint to make day-to-day operations more efficient. The County consolidated six of their utility departments into a single, centralized, cutting edge regional WTP; the Central Regional Utility Service Area (CRUSA). The building was developed in tandem with the new control building for ozone generators on the same site. This building was designed as a viable EOC which included wind rated windows, doors and structural system. The spaces designed include full breakroom, full restroom and shower amenities, readiness rooms and safe spaces. This is the largest water production plant project completed in Polk County.

KEY PERSONNEL: Bradley T. Lunz, Principal in Charge; Trent Chamberlain, Senior Project Architect/QA

BUDGET + SCHEDULE VARIATIONS: N/A, on schedule and on budget.

FIRM RESPONSIBILITY: Architect of Record



# EXPERIENCE, EXPERTISE, **PERSONNEL & TECHNICAL RESOURCES**

## **UTILITIES AND SOLID WASTE FACILITY**

PLANT CITY, FL



**SIZE:** 15,000 SF | **START DATE:** 2021 | **COMPLETION DATE:** IN-PROGRESS, EST. FEBRUARY 2025

**ORIGINAL BUDGET:** \$7.9M | **FINAL COST:** TBD

**PROJECT REPRESENTATIVE:** Hye (Jay) Kwag, CIP, Engineer Manager, City of Plant City | 813.365.4929  
hkwag@plantcitygov.com

### **PROJECT DESCRIPTION**

The City of Plant City is working in collaboration with The Lunz Group for the design and build of a New Facility for their Utilities and Solid Waste Departments. The one story office building will house the Plant City Utilities Management and Solid Waste Management to include their main offices and conference rooms. The new facility will be approximately 15,000 square feet to include an addition of approximately seven (7) new parking spaces. The new parking spaces complement the existing parking lot on the north side of the future facility, which currently has adequate capacity. Services for the new facility include architectural; civil engineering; structural engineering; mechanical, electrical, and plumbing; and fire protection engineering services.

**KEY PERSONNEL:** Bradley T. Lunz, Principal In Charge; Emily Breheny, Project Architect; Trent Chamberlain, Senior Project Architect/QA

**BUDGET + SCHEDULE VARIATIONS:** N/A, on schedule and on budget.

**FIRM RESPONSIBILITY:** Architect of Record

**CONSULTANTS:** MES Group Inc.

# EXPERIENCE, EXPERTISE, PERSONNEL & TECHNICAL RESOURCES

## ORGANIZATION CHART





# EXPERIENCE, EXPERTISE, PERSONNEL & TECHNICAL RESOURCES



## BRADLEY T. LUNZ AIA, NCARB

### *Principal In Charge*

Brad serves as the President and CEO of The Lunz Group. He is an internationally published thought leader, renowned entrepreneur, and registered architect with more than 25 years of architectural experience, and 30 years of construction experience. He has worked on a variety of building typologies including fire stations, aviation facilities, county and state government buildings, public safety facilities, and correctional facilities. Brad strives to provide clients solutions through sustainable designs that last beyond a lifetime. He also strives to engage local manufacturers and suppliers by locally sourcing materials. Brad brings a breadth of experience in resolving a client's spatial and budgetary requirements while delivering a quality design exceeding expectations.

### EDUCATION

Bachelor of Architecture, Savannah College of Art and Design

Master of Architecture, Savannah College of Art and Design

### CREDENTIALS

Florida Registered Architect, AR94778

### YEARS OF EXPERIENCE

25

### YEARS WITH THE LUNZ GROUP

16

### OFFICE LOCATION

Lakeland, FL

### AVAILABILITY FOR PROJECT

10%

### RELATED EXPERIENCE

- Polk County Utilities Operations; Winter Haven, FL
- Polk County Roads & Drainage Office Annex; Winter Haven, FL
- Polk County Sheriff's Ridge District Station at Poinciana; Poinciana, FL
- Polk County Sheriff's Burnham-McCall Training Center; Bartow, FL
- Plant City Utilities & Solid Waste Facility; Plant City, FL
- Polk Regional Water Cooperative Water Processing Facility; Polk County, FL
- Polk County Sheriff's Office Northeast District Command Center; Davenport, FL
- Polk County Fire Station Prototype Design; Polk County, FL
- Polk County Fire Training Center; Polk County, FL
- Vaughn Road Master Plan; Polk County, FL
- Polk County Sheriff's Office Book-In Feasibility Study; Polk County, FL
- Polk County Events Storage & Operations Center; Polk County, FL

### ADDITIONAL EXPERIENCE

- NOAA Aircraft Operations Center Phase I; Lakeland, FL
- NOAA Aircraft Operations Center Phase II; Lakeland, FL
- Lakeland Fire Station No. 7/ARFF (Two Globe Rating)\*; Lakeland, FL
- City of Lakeland Fire Training Facility; Lakeland, FL
- Lakeland Regional Health I-4 & Kathleen Road Medical Office Building; Lakeland, FL
- Summit Consulting Headquarters & Parking Garage; Lakeland, FL
- Treatt USA Headquarters; Lakeland, FL
- R & L Carriers Facility; Lakeland, FL
- Lake Ariana Park; Auburndale, FL
- Southwest Regional Wastewater Treatment Facility Operations; Mulberry, FL
- Winter Haven Fire Station No. 3; Winter Haven, FL
- Winter Haven Fire Station No. 4; Winter Haven, FL
- Winter Haven Fire Station No. 5; Winter Haven, FL
- Pinellas Park Public Works Facility; Pinellas Park, FL
- Osceola County Sheriff's Health Center; Kissimmee, FL



# EXPERIENCE, EXPERTISE, PERSONNEL & TECHNICAL RESOURCES



## **CRAIG FENNIG** AIA, NCARB, LEED AP BD+C *Managing Director*

Craig is the Managing Director at The Lunz Group. He manages the day-to-day operations and acts as a liaison between leadership and production staff. He brings a broad range and depth of experience throughout his architectural and consulting career. He has been a part of a variety of domestic and award-winning international architectural and consulting firms, serving in a multitude of capacities. Craig excels in project management, corporate management, and operations. He has managed projects domestically and internationally at all levels of complex design, construction, and delivery.

### **EDUCATION**

Bachelor of Architecture, Lawrence Technological University

Master of Architecture dual degree in Management, Lawrence Technological University

### **CREDENTIALS**

Registered Architect in the states of Michigan, New York, Connecticut, New Jersey, Ohio, Indiana, Illinois, Arizona, Utah, Kentucky, and Pennsylvania

### **MEMBERSHIPS**

United States Green Building Council (USGBC) Member

International Council of Shopping Centers (ICSC) Member

Urban Land Institute (ULI) Member

### **YEARS OF EXPERIENCE**

30

### **YEARS WITH THE LUNZ GROUP**

1

### **OFFICE LOCATION**

Lakeland, FL

### **AVAILABILITY FOR PROJECT**

5%

### **EXPERIENCE PRIOR TO JOINING THE LUNZ GROUP**

- Mall of Saud, Riyadh, Saudi Arabia - (CRTKL)
- Mall of Saudi (ULO) - Ski, Riyadh, Saudi Arabia - (CRTKL)
- Mall of Emirates ULO -Ski, Dubai, UAE - (CRTKL)
- Lalaport Mall, Taipei Taiwan - (CRTKL)
- MXD Nanjing Jiangbei New District, Namjing Jiangsu, China - (CRTKL)
- SCE Shanghai Zhongjun Huacao Town, Shanghai, China - (CRTKL)
- Centralcon Shenzhen Xixiang, Shenzhen, China - (CRTKL)
- Fulton Market, Chicago - (CRTKL)
- Rose and Loon Makers Market, Roseville, MN - (CRTKL)
- Stony Point Fashion Park, Richmond, VA - (CRTKL)
- La Plaza, McAllen, TX - (CRTKL)
- Cityplace, Dallas, TX - (CRTKL)
- Corinth Square Shops, Prairie Village, KS - (CRTKL)
- Rosedale Center, Roseville, MN - (CRTKL)
- Roosevelt Field Mall Expansion & Renovation, Long Island, NY - (CRTKL)
- Dadeland Mall Expansion & Renovation, Miami, FL - (CRTKL)
- Frisco Station Hub Mixed Use Development, Frisco, TX - (CRTKL)
- Northfield Shops Mixed Use Development, Northfield, CO - (CRTKL)
- Victory Park Retail, Dallas, TX - (CRTKL)
- YH Global Headquarters, Shanghai, China - (CRTKL)
- DFW China Town Mixed Use Development, Richardson, TX - (CRTKL)
- Village on the Parkway Office Tower, Dallas, TX - (CRTKL)
- Cleburne Station Retail Development, Cleburne, TX - (CRTKL)
- Rice Village Retail Renovation, Houston, TX - (CRTKL)
- Cottonwood Mixed Use Development, Salt Lake City, UT - (CRTKL)
- Bonofico High Street Mixed-Use Development, Manila, Philippines - (A3)
- BCG East Block Mixed Use Development, Makati, Philippines - (A3)
- Sapporo Office Building, Sapporo, Japan - (A3)
- Arbor Hills Crossing Retail Development, Ann Arbor, MI - (A3)
- Delphi World Headquarters Renovation, Auburn Hills, MI - (A3)





# EXPERIENCE, EXPERTISE, PERSONNEL & TECHNICAL RESOURCES



## GREG SELVIDGE RRC

### *Senior Project Manager*

Greg brings more than 25 years of experience specifically in fire station design and construction. Greg has a strong background in construction, architecture, and product design, especially as they relate to fire stations. Greg strives to provide clients with design solutions that are tailored to their needs and has extensive experience with construction administration and project management. He has worked on more than 30 fire stations throughout his career. Greg is currently working closely with the City of Apopka and Highlands County on fire station projects, as well as Polk County, with multiple fire stations in construction phases. Greg will be the main point of contact for the design team and will be responsible for project oversight and coordination.

### EDUCATION

Bachelor of Architecture, Georgia Institute of Technology

### CREDENTIALS

Florida Registered Residential Contractor, RR282811816

### YEARS OF EXPERIENCE

26

### YEARS WITH THE LUNZ GROUP

23

### OFFICE LOCATION

Lakeland, FL

### AVAILABILITY FOR PROJECT

50%

### RELATED EXPERIENCE

- Polk County Roads & Drainage Office Annex; Winter Haven, FL
- Polk County Sheriff's Ridge District Station at Poinciana; Poinciana, FL
- Polk County Sheriff's Office Burnham-McCall Training Center; Bartow, FL
- Polk County Fire Training Center; Polk County, FL
- Polk County Fire Station Prototype; Polk County, FL
- Polk County Sheriff's Office Intake Facility Renovation; Polk County, FL
- Vaughn Road Master Plan; Polk County, FL
- Pinellas Park Public Works Facility; Pinellas Park, FL
- Durbin Park Community Center; Kissimmee, FL
- Lake Myrtle Park; Auburndale, FL
- Mulberry Fire Station; Mulberry, FL
- Four Corners Fire Rescue; Four Corners, FL

### ADDITIONAL EXPERIENCE

- Winter Haven Fire Station No. 2 Hardening; Winter Haven, FL
- South Lake Howard Nature Park Expansion; Winter Haven, FL
- Mulberry Fire Station; Mulberry, FL
- Marion County EMS Prototype Design; Marion County, FL
- Sanford Fire Station No. 40; Sanford, FL
- Sleepy Hill Fire Station; Lakeland, FL
- Galloway Fire Station; Lakeland, FL
- Apopka Fire Station No. 5; Apopka, FL
- Apopka Fire Station No. 6; Apopka, FL
- Haines City Fire Station; Haines City, FL
- Southwest Sumter Fire Station; Sumter County, FL
- North Wildwood Fire Station; Sumter County, FL
- Watkins Road Fire Rescue; Haines City, FL
- Northeast Regional Park Baseball Complex; Davenport, FL



# EXPERIENCE, EXPERTISE, PERSONNEL & TECHNICAL RESOURCES



## EMILY BREHENY RA, NCARB

### *Project Architect*

Emily joined The Lunz Group in 2016 upon graduating with her Master's in Architecture from the University of South Florida. She has a strong background in various levels of design development, programming, master planning, and schematic design, specializing in municipal projects. In the last three years, Emily has worked on more than 10 public safety facilities, including fire stations, Sheriff operation centers, and more, throughout the Central Florida region. She has a strong background in various levels of design development, programming, master planning, and schematic design, specializing in municipal projects.

### EDUCATION

Master of Architecture, University of South Florida

### CREDENTIALS

Florida Registered Architect, AR102495

### MEMBERSHIPS

Lakeland Zoning Board of Adjustments & Appeals (ZBAA), Member

Polk County ACE Mentor Program, Board Member

### YEARS OF EXPERIENCE

9

### YEARS WITH THE LUNZ GROUP

8

### OFFICE LOCATION

Lakeland, FL

### AVAILABILITY FOR PROJECT

70%

### SELECT EXPERIENCE

- Polk County Sheriff's Office Burnham McCall Training Center; Polk County, FL
- Polk County Sheriff's Ridge District Station at Poinciana; Poinciana, FL
- Polk County Roads & Drainage Office Annex; Winter Haven, FL
- Plant City Utilities & Solid Waste Facility; Plant City, FL
- Marion County Sheriff's Office Remodel; Ocala, FL
- Marion Creek Fire Rescue; Polk County, FL
- Mulberry Fire Station; Mulberry, FL
- Marion County Sheriff's Helicopter Hangar Design; Ocala, FL
- Hillsborough County Sheriff Behavioral Health Clinic Study; Tampa, FL
- Hillsborough County Sheriff Behavioral Health Clinics A-C; Tampa, FL
- Pasco County Fleet McKendree Expansion; Pasco County, FL
- Polk Correctional Institution Administration Remodel; Polk City, FL
- GMF Steel Group Office and Warehouse Renovation; Lakeland, FL

### ADDITIONAL EXPERIENCE

- NOAA Operations Center Phase I; Lakeland, FL
- NOAA Operations Center Phase II; Lakeland, FL
- Summit Consulting Headquarters and Parking Garage; Lakeland, FL
- Bartow Ford Pro Elite Service Center; Bartow, FL
- Publix Downtown Office Buildings 1 and 4; Lakeland, FL
- Blue Line Aviation Facility; Winter Haven, FL
- Kingsky Flight Academy Programming and Conceptual Design; Lakeland, FL
- City of Lakeland Two Hangar Facility; Lakeland, FL
- Winter Haven Fire Station No. 4; Winter Haven, FL
- Winter Haven Fire Station No. 5; Winter Haven, FL
- Plant City Tournament Management Facility; Plant City, FL
- Plant City Methvin Tennis Center; Plant City, FL
- Lake Myrtle Sports Complex; Auburndale, FL
- Catapult 3.0; Lakeland, FL





# EXPERIENCE, EXPERTISE, PERSONNEL & TECHNICAL RESOURCES



## TRENT CHAMBERLAIN AIA

*Senior Project Architect, QA*

Trent is a Senior Project Architect, QA (Quality Assurance) at The Lunz Group. He acts as a third-party to the project to check drawings through a detailed review. Trent specializes in municipal, transportation, and correctional facility design. He has experience working with local city, county, and state and federal agencies including municipalities, the Florida Department of Corrections and the United States Postal Service. He has experience working on a variety of project typologies, including academic buildings, fire stations, correctional facilities, public and civic facilities, and more. Trent has a strong technical background from experience gained working as a Project Manager at several engineering firms and from more than 30 years with The Lunz Group.

### EDUCATION

Bachelor of Architecture, Florida Agricultural & Mechanical University

### CREDENTIALS

Florida Registered Architect, AR0015550

### YEARS OF EXPERIENCE

35

### YEARS WITH THE LUNZ GROUP

31

### OFFICE LOCATION

Lakeland, FL

### AVAILABILITY FOR PROJECT

5%

### RELATED EXPERIENCE

- Polk County Sheriff's Office Boot Camp; Bartow, FL
- Polk County Utilities Operations; Winter Haven, FL
- Polk County Roads & Drainage Office Annex; Winter Haven, FL
- Polk County Sheriff's Ridge District Station at Poinciana; Poinciana, FL
- Polk County Sheriff's Burnham-McCall Training Center; Bartow, FL
- Plant City Utilities & Solid Waste Facility; Plant City, FL
- Hillsborough County Sheriff's Office Regional Canine Training Facility; Tampa, FL
- Osceola County Sheriff's Health Center Office; Kissimmee, FL
- Florida Department of Corrections Continuing Services; Statewide, FL
- Saddle Creek Warehouse; Auburndale, FL
- Saddle Creek Warehouse + Office Expansion; Auburndale, FL
- Sumter County Fire Logistics Operations Center; Sumter County, FL
- Watkins Road Fire Rescue; Haines City, FL
- Polk Correctional Institution Administration Remodel; Polk City, FL

### ADDITIONAL EXPERIENCE

- NOAA Aircraft Operations Center Phase I; Lakeland, FL
- NOAA Aircraft Operations Center Phase II; Lakeland, FL
- United States Postal Service Design Standards; Nationwide
- Summit Consulting Headquarters and Parking Garage; Lakeland, FL
- Lakeland Fire Station No. 7/ARFF (Two Globe Rating)\*; Lakeland, FL
- Alachua County Fire Station No. 80; Alachua, FL
- Austin-Tindall Regional Park Expansion; Kissimmee, FL
- Northeast Regional Park Baseball Complex; Davenport, FL
- World Equestrian Center Show Arena Complex; Ocala, FL
- World Equestrian Center RV Park Building; Ocala, FL
- Summit Consulting Headquarters + Parking Garage; Lakeland, FL
- Alachua County Fire Station No. 21; Alachua, FL
- Sanford Fire Station No. 40; Sanford, FL
- City of Lakeland Fire Training Facility; Lakeland, FL
- Bonnet Springs Park; Lakeland, FL



# EXPERIENCE, EXPERTISE, PERSONNEL & TECHNICAL RESOURCES



**THE LUNZ GROUP** has intentionally selected this team of experts to provide Subject Matter Expertise and Engineering services for this Polk County project. Our firm has held long standing relationships with each consultant, with almost all consultants participating in Polk County projects alongside The Lunz Group. We present to you our highly-qualified team of experts:

**JOHNNIE LOHRUM** will serve as the Subject Matter Expert for this project. Johnnie has 23 years of experience and has managed more than 5 million square feet of public safety projects. He is a licensed architect and LEED accredited professional with a diverse portfolio of project types, including public safety, educational, community, commercial and aviation design. He has spent the last 15 years focusing on growing a public safety market that improves the community environment. A particular passion for Johnnie is the design of operationally efficient healthy law enforcement facilities. He also brings a significant amount of experience designing & detailing hardened, survivable and essential facilities such as the Columbia County EOC, Sarasota County EMS Headquarters, Charlotte County Sheriff's Headquarters, Brevard County EOC and the Volusia County EOC. Johnnie remains focused on providing personally dedicated and focused attention at every level to all of his clients. Johnnie's office is located in Longwood, FL, which can be utilized to expedite a deliverable if required.



**TLC ENGINEERING** will be providing Structural Engineering Services for this project. The TLC team is experienced with the desired tilt-wall construction system and will share feedback with the design team on how to be successful with tilt-wall construction. Further design decisions will weigh various factors such as structural integrity, longevity and safety risks, maintenance of materials, local material availability, and current market costs. TLC has experience in Polk County on projects such as the Burnham-McCall Training Center, as well as the Polk County Northeast Government Center in Lake Alfred. TLC's Tampa, Orlando, Melbourne, and Miami offices that can be utilized to expedite a deliverable, if required.



**KIMLEY-HORN & ASSOCIATES** will be providing Civil Engineering services for this project. Kimley-Horn's Polk County project experience includes; Galloway Fire Station, Moore Road Fire Rescue Station, Eaton Park Fire Station Sheriff Central County Jail, Sheffield Road Inspection and Testing Building and Fleet Management Vehicle Storage Building, to name a few. Kimley-Horn is familiar with Polk County processes and best practices. Kimley-Horn's Lakeland, St. Petersburg, and Orlando office can be utilized to expedite a deliverable, if required.

**MES GROUP INC.** will be providing Mechanical Engineering, Electrical Engineering, Plumbing Engineering and Fire Protection services for this project. MES Group has worked on a variety of Polk County Fire Stations and facilities. One of MES Group's strengths is anticipating supply chain disruptions; for this project, they plan to be proactive with assisting the team in pre-ordering critical materials for this facility to avoid delays and cost increases, as well as flexible options to ensure availability and stay within budget.



# EXPERIENCE, EXPERTISE, PERSONNEL & TECHNICAL RESOURCES



## Johnnie D. Lohrum Jr., RA, LEED® AP President

Johnnie has 23 years of experience and has managed more than 5 million square feet of public safety projects. He is a licensed architect and LEED accredited professional with a diverse portfolio of project types, including public safety, educational, community, commercial and aviation design. He has spent the last 15 years focusing on growing a public safety market that improves the community environment. **A particular passion for Johnnie is the design of operationally efficient healthy law enforcement facilities.** He also brings a significant amount of experience designing & detailing hardened, survivable and essential facilities such as the Columbia County EOC, Sarasota County EMS Headquarters, Charlotte County Sheriff's Headquarters, Brevard County EOC and the Volusia County EOC. Johnnie remains focused on providing personally dedicated and focused attention at every level to all of his clients.

### EDUCATION

Bachelor of Design, 2001  
University of Florida

Master of Architecture, 2003,  
University of Florida

### CREDENTIALS

FL, Registered Architect #AR96099  
LEED® Accredited Professional

### AFFILIATIONS

Florida Police Chief's Association (FPCA)  
Florida Sheriff's Association (FSA)  
Florida Fire Chief's Association (FFCA)  
Fl. Emergency Preparedness Assoc. (FEPA)

### EXPERIENCE

22 Years

### FIRM INFORMATION

1678 Kingston Road  
Longwood, Florida 32750

jlohrum@jl2architecture.com  
407.340.2879

\*projects represent individual experience for Mr. Lohrum

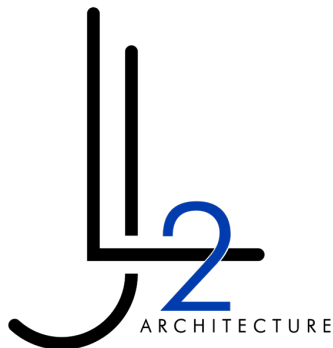

#### **\*District 7 Medical Examiner Facility**, Volusia County Government - *Daytona, FL*

Principal In Charge, Completion Date: est. 2023 / 20,000 SF / \$18 million / contains public spaces / **N.A.M.E.** / offices / reception & lobby / morgue / laboratories / evidence storage / break areas and enclosed sally port.

#### **\*Havert L. Fenn Center**, St. Lucie County Government - *Ft. Pierce, FL*

Project Manager, Completion Date: 2006 / 62,000SF / \$12.6 million / contains law enforcement offices / commercial kitchen / laundry / locker rooms / EMS triage areas / triple gymnasium / multi-purpose rooms / essential FEMA 361 resisting 180mph winds / special needs shelter for the elderly.

#### **\*Douglas M. Anderson EOC**, St. Lucie County Government - *Ft. Pierce, FL*

Project Manager, Completion Date: 2009 / 27,000SF / \$9 million / contains secure lobby / 911 dispatch / dorms / admin. offices / media room / kitchen.

#### **\*Emergency Operations Center**, Palm Beach Gardens Government - *Palm Beach Gardens, FL*

Project Architect, Completion Date: 2012 / 12,500SF / \$3.1 million / police dispatch / multi-purpose rooms / operations center / classrooms / training rooms / kitchen / FEMA 361 / LEED Silver.

#### **Emergency Operations Center & Sheriff's Operations**, Citrus County - *Lecanto, FL*

Project Architect, Completion Date: 2008 / 40,500SF / \$16.5 million / 911 call center / operations room / crime analysis / investigations / offices / kitchen / dorms / fitness room / media.

#### **Emergency Operations & Sheriff's Comms. Center**, Volusia County - *Daytona, FL*

Project Manager, Completion Date: 2013 / 42,600SF / \$10,700,000 / command center / 911 dispatch / Green Globes / LEED Silver / 2 commercial kitchens / bunk rooms / classrooms / training rooms / media room / administration offices / rumor control.

#### **\*Emergency Operations Center**, Columbia County - *Lake City, FL*

Principal In Charge, Completion Date: Est. 2023 / 20,000SF / \$14 million / 911 dispatch center / ICC 500 essential facility / media room / kitchen / code enforcement.

#### **\*Brevard County EOC**, Brevard County Government - *Rockledge, FL*

Principal-In-Charge/Project Manager, Completion Date: est. 2023 / 50,000 SF / \$28.5 million / contains secure lobby / locker rooms / bunk rooms / training rooms / multiple departments / commercial kitchen / 911 dispatch / operations room / media room / essential ICC 500 resisting 200mph winds / grant funded / 24-7 fully redundant systems for 7 days.

#### **\*Sheriff's Evidence Storage**, Volusia County Government - *Daytona, FL*

Project Manager, Completion Date: est. 2021 / 40,000 SF / \$11.3 million / contains public spaces / offices / secure vehicular sally ports / bio hazard storage / storage warehouse with mobile storage system / secure drug storage / essential facility resisting 200mph winds / LEED Silver.

#### **\*University of Florida Public Safety Headquarters**, University of Florida - *Gainesville, FL*

Principal-In-Charge, Completion Date: 2022 / 48,713SF / \$28.5 million / police headquarters / emergency management headquarters / 911 dispatch / community rooms / administration offices / interview rooms / physical fitness / locker rooms / evidence processing / defensive tactics / armory / media room / logistics / quarter master.

# EXPERIENCE, EXPERTISE, PERSONNEL & TECHNICAL RESOURCES



## EDUCATION

Bachelor of Design, 2001  
University of Florida

Master of Architecture, 2003,  
University of Florida

## CREDENTIALS

FL, Registered Architect #AR96099  
LEED® Accredited Professional

## AFFILIATIONS

Florida Police Chief's Association (FPCA)  
Florida Sheriff's Association (FSA)  
Florida Fire Chief's Association (FFCA)  
Fl. Emergency Preparedness Assoc. (FEPA)

## EXPERIENCE

22 Years

## FIRM INFORMATION

1678 Kingston Road  
Longwood, Florida 32750

jlohurm@j12architecture.com  
407.340.2879

\*projects represent individual experience for Mr. Lohurm

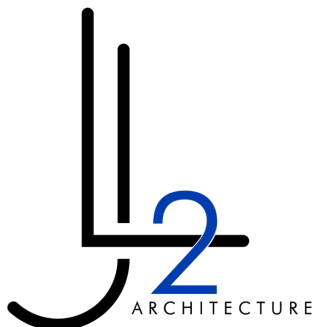

### **\*Sheriff's Training Facility, Osceola Sheriff - Osceola County, FL**

Principal In Charge, Completion Date: 2021 / 16,400SF / \$3.9 million / defensive tactics / simulation training / firearm training / administration offices / conference space / storage / multi-agency.

### **\*Sheriff's Data Center, Osceola Sheriff - Kissimmee, FL**

Project Manager, Completion Date: 2022 / 1,500SF / \$1.1 million / back up data center for sheriff's headquarters / fully redundant systems / renovation-expansion.

### **\*Sheriff's West Side Command Center, Osceola County - Kissimmee, FL**

Principal In Charge, Completion Date: TBD / 41,000SF / \$18 million / multi-agency / training rooms / conference rooms / administration offices / secure public lobby / interview rooms / patrol offices / shared with other county departments.

### **\*Police Headquarters, North Port Police Department - City of North Port, FL**

Project Manager, Completion Date: 2026 / 120,000SF / \$82 million / administration offices / patrol / EOC / evidence processing / interview rooms / community room / media room / quarter master / emergency management / locker rooms / forensics lab / armory / training / gun range/ real time crime center

### **\*Police Training Facility, Cape Coral Police Department - Cape Coral, FL**

Principal In Charge, Completion Date: 2023 / 30,000SF / \$12 million / indoor 25 lane gun range / firearm simulators / defensive tactics / k9 training / locker rooms / armory / ammo storage / weapons cleaning / training classrooms.

### **\*Sheriff's Headquarters Assessment, Sarasota County Sheriff - Sarasota County, FL**

Project Manager, Completion Date: 2018 / 192,000SF / \$130 million / forensics lab / separate training facility / five-story parking garage / CEP / evidence storage / training classrooms / community room / K9 training

### **\*Sheriff's Headquarters/911/Communications, Charlotte County Sheriff - Charlotte County, FL**

Project Manager, Completion Date: 2025 / 65,000SF / \$30 million / 2- story community room / administration offices / fleet maintenance / real time crime center / 911 dispatch / crime analysis.

### **\*Sheriff's District 4 Training Facility, Charlotte County Sheriff - Charlotte County, FL**

Project Manager, Completion Date: 2024 / 20,200SF / \$7 million / meeting rooms / training classrooms / physical training / administration offices / k-9 training / kennels / lockers / fitness room / evidence storage / detectives suite / break room

### **Police Evidence Storage, City of DeLand Police Department - DeLand, FL**

\*Project Manager, Completion Date: 2022 / 5,500 SF / \$1.9 million / public ballistic rated lobby / evidence intake / short term storage / long term storage / evidence processing lab / vehicle processing bay / bicycle storage / interior vehicle storage bays / on-site impound.

### **Indian River Sheriff Admin. Building, Indian River Sheriff's Office- Indian River County, FL**

Architect of Record, Completion Date: Est. 2025 / 20,000SF / \$22 million / 2-story / essential facility / administration offices / records / training rooms / human resources / finance / IT / internal affairs / purchasing / secured public lobby.

### **Volusia County Sheriff Admin. Building, Volusia County Sheriff - Volusia County, FL**

Architect of Record, Completion Date: TBD / 80,000SF / \$55 million / 2-story / needs assessment / community room / administration offices / training rooms / classrooms commercial kitchen / internal affairs / ISS / patrol / special investigations / human resources / sally port / essential facility.

### **Orange City Police Department, Orange City PD - Orange City, FL**

Architect of Record, Completion Date: 2026 / 30,000SF / \$25 million / 1-story / needs assessment / community room / administration offices / training rooms / classrooms commercial kitchen / City EOC / records / investigations / command / defensive tactics / fitness & lockers / hold cells / indoor shooting range / logistics building / evidence / sally port / essential facility.

### **Daytona Beach Shores Training & Evidence, Daytona Beach Shores PD/Fire - DB Shores, FL**

Architect of Record, Completion Date: 2026 / 20,000SF / \$14 million / 2-story / needs assessment / community room / administration offices / training rooms / classrooms commercial kitchen / City EOC / defensive tactics / fitness & lockers / evidence / essential facility.

### **Marion County Sheriff's Administration Facility**



# EXPERIENCE, EXPERTISE, PERSONNEL & TECHNICAL RESOURCES



## Jason Alligood, PE

Civil Engineer

### PROJECT EXPERIENCE

**Hamilton Road Warehouse, Polk County, FL** — Project manager and Engineer of Record (EoR). Kimley-Horn was responsible for providing professional engineering services for a warehouse building in Polk County. The building had a total area of approximately 317,000 square feet. The project site posed several challenges, including difficult terrain, wetlands, and floodplains. These conditions required a site design with high tolerance and the acquisition of permits from various authorities, including Polk County, the Florida Department of Environmental Protection (FDEP), the Florida Department of Health, and the Southwest Florida Water Management District.

**Winston Creek Fire Rescue Station, Polk County, FL** — Project engineer/Engineer of Record (EoR). Kimley-Horn provided civil site design, environmental, permitting services, and construction phase services for the Winston Creek Fire Rescue Station. The project included a 12,000-square-foot building with associated paved parking, drive, stormwater areas, and utility connections. The site included adjacent wetlands and floodplains that required strategic site planning. In addition, the property was within an area considered to be a distressed basin by Polk County requiring more stringent stormwater design.

**Airport Logistics Warehouse, Hillsborough County, FL** — Kimley-Horn was responsible for providing professional engineering services for a warehouse building measuring 125,600 square feet in Hillsborough County. The project site presented several challenges, including difficult terrain, wetland and floodplain conditions that required a meticulous site design, and the need for complex coordination with various agencies for permits. These agencies included Hillsborough County, the Florida Department of Environmental Protection (FDEP), the Florida Department of Health, the Southwest Florida Water Management District (SWFWMD), the Environmental Protection Commission (EPC) of Hillsborough County, and the U.S. Army Corps of Engineers (USACE).

Prior to joining Kimley-Horn, Jason worked on the following projects:

**Mulberry Fire Rescue Station, Polk County, FL** — Project engineer/Engineer of Record (EoR) for civil site design, permitting services, and construction phase services for the Mulberry Fire Rescue Station. The project included a 12,000-square-foot building with associated paved parking, drive, stormwater areas, and utility connections.

**Kathleen Fire Rescue Station, Polk County, FL** — Project engineer/Engineer of Record (EoR) for civil site design, permitting services, and construction phase services for the Kathleen Fire Rescue Station. The project included a 12,000-square-foot building with associated paved parking, drive, stormwater areas, and utility connections. The site required 100-year stormwater design.

**Lakeland Fire Training Center, Polk County, FL** — Project engineer/Engineer of Record (EoR) for civil site design, environmental, permitting services, and construction phase services for the Lakeland Fire Training Center. The project included a 5,000-square-foot classroom building and an 8,400-square-foot equipment storage building with associated paved parking, drive, stormwater areas, and utility connections.

### Special Qualifications

- Jason has over 22 years of multi-discipline engineering experience working for both municipal and private-sector clients in the areas of civil engineering, geotechnical engineering, and environmental engineering
- Project experience includes project management, design, permitting, and construction services for residential developments, commercial developments, water distribution and wastewater collection, industrial developments, streetscape projects, parks, and landfills
- Familiar with all aspects of the site development process — from the earliest stages of due diligence and entitlements to inspection and final punch lists

### Professional Credentials

- Master of Engineering, Environmental Engineering, University of Florida
- Bachelor of Science, Civil Engineering, Florida State University
- Professional Engineer in Florida, #71103
- American Society of Civil Engineers (ASCE), Member

**Kimley»Horn**

# EXPERIENCE, EXPERTISE, PERSONNEL & TECHNICAL RESOURCES



## Jason Lewis, PE

Civil Engineer

### PROJECT EXPERIENCE

**Pace Road Industrial Park, Polk County, FL** — Project Engineer. Kimley-Horn is providing preliminary design services for the construction of a warehouse/distribution park located on Pace Road in Auburndale. Our services include producing a one-page conceptual site plan, attending meetings and coordinating with Polk County, conducting a Phase I Environmental Site Assessment (ESA), and Phase II ESA. The Phase I ESA includes conducting a site reconnaissance; interviewing current and past owners, operators, and occupants for Recognized Environmental Conditions (RECs); and preparing a summary report of the results of the ESA. The Phase II ESA includes soil sampling, groundwater sampling, and preparing a Phase II ESA report. Kimley-Horn submitted and received both the Southwest Florida Water Management District (SWFWMD) and FWC gopher tortoise relocation permit. These permits included conducting a 100% gopher tortoise survey, permit application submittal, and conducting the excavation of 40 gopher tortoise burrows.

**Polk State College Center for Public Safety, Polk County, FL** — Project Engineer. Kimley-Horn provided professional engineering services for a new 100,000-square-foot, two-story building and a one-mile-long pedestrian path for the Center for Public Safety at Polk State College. The pedestrian path is located on the bank of a 26-acre retention pond owned by Polk County, with a physical training course. The project included stormwater management, parking lot design, an underground tank for rainwater irrigation and water storage, a new sanitary sewer lift station, new fire lines and a new potable water line, and environmental studies. The \$30-million project included construction phase management and achieved Leadership in Energy and Environmental Design (LEED) certification. The project also won the American Society of Civil Engineering (ASCE) Ridge Branch project of the year award and is the county's model for law enforcement training.

**City of Lake Wales Engineering and Related Services, Polk County, FL** — Project Manager. Kimley-Horn provided professional consulting services for the general engineering services master consultant contract by the Town of Lake Wales. Specific services included civil engineering, planning, landscape architecture, parks and trails planning and design, and a variety of other consulting services.

**Parkway University Center, Polk County, FL** — Project Manager. The project included professional civil engineering and site planning services for the 105-acre, multi-use development. Specific services included stormwater management design, potable water distribution, and sanitary sewer collection infrastructure design to support residential and business park components. In addition, Kimley-Horn also coordinated road design and associated alignments with Polk County for an adjacent county road project.

**Seefried Industrial Properties, Big Bend Industrial Park, Apollo Beach, FL** — Project manager. In support of Seefried Industrial Properties, Inc., who is constructing a 500,000-square-foot warehouse/distribution facility and associated infrastructure on US Hwy 41 and Big Bend Road, Kimley-Horn is providing an array of development services including a natural resource assessment, environmental documentation, traffic study, and more.

### Special Qualifications

- Jason has over 24 years of experience in civil engineering for both private and public land development projects
- He has performed analysis and designed stormwater management systems, including underground exfiltration and above-ground retention/detention systems
- He has established excellent working relationships with water management districts and other governmental agencies
- In addition, Jason has managed the preparation of plans and development of civil engineering design for numerous commercial and residential land development projects including stormwater collection design; evaluation of site characteristics for the design of roads, utilities, and stormwater management; and project coordination, communication with contractors, and permitting through regulatory agencies

### Professional Credentials

- Bachelor of Science, Civil Engineering, University of Central Florida
- Professional Engineer in Florida, #62572
- Florida Engineering Society (FES), Member

**Kimley»Horn**



# EXPERIENCE, EXPERTISE, PERSONNEL & TECHNICAL RESOURCES



## JAMESE SPEARS, PE

Principal | Structural Project Manager

### BACKGROUND

Jamese brings unparalleled expertise to guide and elevate the success of complex structural projects. She has a successful background in structural design coordination, and construction administration of building structures. She is proficient in utilizing engineering software, such as BIM, to create cost-effective and sustainable solutions. Jamese is a driven professional known for fostering collaboration and exceeding clients' expectations.

### EXPERIENCE

#### **Polk County Sheriff Training Facility, Bartow, Florida**

New administration and classroom single-story sheriff training facility. Design and construction consists of new PEMB building, various site improvements including storm water pond construction, new utility connections, drives, landscaping, and parking areas. Post construction removal and disposal of existing modular building structures, site cleanup, grading, and sodding are included in scope. \$3.5 million / 22,000 sf

#### **Charlotte County Sheriff Office District 1 Headquarters, Englewood, Florida**

New facility with consideration of life-cycle costs, long-term maintenance, energy conservation and long-term operational costs. Project includes roll call room and supervisor offices, detective work area with interview rooms, records room, training room, evidence room, armory area and other ancillary functions, emergency generator, exercise area with locker room and showers, general offices and storage areas. \$3.3 million / 12,000 sf

#### **Charlotte County Sheriffs District 3 Headquarters, Port Charlotte, Florida**

New facility consists of two separate buildings: an 18,000-sf district facility and a 20,000-sf evidence facility. District facility building houses offices, interview rooms, record room, training room, armory, exercise area with lockers and showers, and ancillary support spaces such as storage and mechanical/ electrical rooms. Evidence facility building has warehouse storage, office space, processing areas, and exterior storage. \$8.5 million / 38,000 sf

#### **New Orleans Police Department, 2nd District, New Orleans, Louisiana**

New police district headquarters with distinctive design. The project was part of the resilience planning which occurred as a response to Hurricane Katrina to build resilient infrastructure while reestablishing public service facilities. The structural system includes steel framing with a dual lateral system of braced frames and moment frames. The long span metal roof deck is supported by curved WF steel beams. \$6.3 million / 18,000 sf

#### **Confidential Industrial Warehouse Addition, Lenexa, Kansas**

Two-story addition providing office space, a larger break room, and larger main restrooms on the first floor. Project includes a new FEMA storm shelter. \$1 million / 6,400 sf



### EDUCATION

University of Louisville  
M.S., Structural Engineering  
2009

University of Louisville  
B.S., Civil Engineering  
2008

### YEARS OF EXPERIENCE

TLC: 9 years  
Prior: 9 years

### REGISTRATIONS

PE FL 82786  
PE AL 53112  
PE DE 27703  
PE KS PE28279  
PE KY 29138  
PE MS 31854

# EXPERIENCE, EXPERTISE, PERSONNEL & TECHNICAL RESOURCES



**David Keith, PE, CxA**  
**Electrical Engineer**

Mr. Keith has extensive experience in all phases of Electrical Engineering services including design, studies, and reports. He is a leader in design for innovative electrical systems for police and fire stations, multifamily complexes, county buildings, offices, and industrial complexes. His technical experience includes the design of outdoor and indoor substations, outdoor and indoor power distribution systems, emergency power generator systems, grounding systems, lighting systems, life safety systems, lightning protection systems, and technology systems. Mr. Keith has designed and managed projects for both public and private sector clients.



**Years of Experience: 11 | Years with Firm: 6**

## EDUCATION

**Bachelor of Science in Engineering**  
*University of South Florida*

## REGISTRATIONS/CERTIFICATIONS

- Licensed Professional Engineer (PE) FL #85291
- Florida Advance Building Code Course
- Certified CxA

## RECENT PROJECT EXPERIENCE

**Burnham-McCall Sheriff Training Center, Bartow, FL**

**Polk County Jail Annex, Bartow, FL**

**Polk County South Jail AHUs, Frostproof, FL**

**Polk County Appraiser, Bartow, FL**

**Polk County Jail Grounding, Frostproof, FL**

**Northridge Fire Rescue Station Study, Davenport, FL**

**Police Department Firing Range, St. Petersburg, FL**

**Renovate Police Operations Center, VA Hines, Indianapolis, IN**

**City of Wildwood HVAC Renovation, Wildwood, FL**

**Sheriff's Impound Yard/Evidence Storage, Bushnell, FL**

550 North Reo Street | Suite 203 | Tampa, FL 33556  
(813) 289-4700  
[www.MESGroupInc.com](http://www.MESGroupInc.com)



# EXPERIENCE, EXPERTISE, PERSONNEL & TECHNICAL RESOURCES



**Nick Stephenson, (F)PE, BCxP**  
**Plumbing/Fire Protection Engineer**

Mr. Stephenson is a registered Fire Protection Engineer and has extensive experience with life safety systems, fire detection and suppression systems, and fire alarm systems. This includes design, studies, on-site assessments and reports. His project experience encompasses police and fire stations, multifamily complexes, county buildings, offices, and industrial complexes. Mr. Stephenson has designed and managed projects for both public and private sector clients. In addition to his engineering credentials, he is a certified Building Commissioning Professional (BCxP).



**Years of Experience: 12 | Years with Firm: 10**

## EDUCATION

**Bachelor of Science in Mechanical Engineering**  
*University of South Florida*

## REGISTRATIONS/CERTIFICATIONS

- Licensed Professional Engineer (PE) FL #83283
- Florida Advance Building Code Course
- Certified BCxP

## RECENT PROJECT EXPERIENCE

**Burnham-McCall Sheriff Training Center, Bartow, FL**

**Polk County Jail Annex, Bartow, FL**

**Polk County South Jail AHUs, Frostproof, FL**

**Polk County Appraiser, Bartow, FL**

**Polk County Jail Grounding, Frostproof, FL**

**Northridge Fire Rescue Station Study, Davenport, FL**

**Police Department Firing Range, St. Petersburg, FL**

**Renovate Police Operations Center, VA Hines, Indianapolis, IN**

**City of Wildwood HVAC Renovation, Wildwood, FL**

**Sheriff's Impound Yard/Evidence Storage, Bushnell, FL**

550 North Reo Street | Suite 203 | Tampa, FL 33556  
(813) 289-4700  
[www.MESGroupInc.com](http://www.MESGroupInc.com)

# EXPERIENCE, EXPERTISE, PERSONNEL & TECHNICAL RESOURCES



**Philip Beauchamp, PE**  
**Mechanical Engineer**

Mr. Beauchamp has extensive experience in all phases of Mechanical Engineering services including design, studies, and reports. He is a leader in the design of energy efficient building systems for fire stations, police stations, shooting ranges, EMS facilities, county buildings, offices and industrial complexes. Systems included HVAC, smoke exhaust, indoor air quality and controls. He has developed energy-efficient, and cost effective, mechanical systems and methods that specifically control the humidity and moisture conditions of Florida's hot and humid climate. Mr. Beauchamp's designs provide comfort to occupants and protection of building systems and components.



**Years of Experience: 6 | Years with Firm: 2**

## EDUCATION

**Bachelor of Science in Mechanical Engineering**  
*University of Georgia*

## REGISTRATIONS/CERTIFICATIONS

- Licensed Professional Engineer (PE) FL #PE97350

## RECENT PROJECT EXPERIENCE

**Burnham-McCall Sheriff Training Center,** *Bartow, FL*

**Polk County Jail Annex,** *Bartow, FL*

**HSCO Behavioral Health Clinic,** *Tampa, FL*

**Fire Station 2-Hardening,** *Winter Haven, FL*

**Research Laboratory Hood Additions.** *University of Central Florida, Orlando, FL*

**Northridge Fire Rescue Station Study,** *Davenport, FL*

**Police Department Firing Range,** *St. Petersburg, FL*

**Renovate Police Operations Center,** *VA Hines, Indianapolis, IN*

**City of Wildwood HVAC Renovation,** *Wildwood, FL*

**Sheriff's Impound Yard/Evidence Storage,** *Bushnell, FL*

550 North Reo Street | Suite 203 | Tampa, FL 33556  
(813) 289-4700  
[www.MESGroupInc.com](http://www.MESGroupInc.com)





POLK COUNTY SHERIFF'S OFFICE  
Ridge District Station at Poinciana

# TAB 4

IS THE FIRM A “POLK COUNTY  
ENTITY”?

# IS THE FIRM A “POLK COUNTY ENTITY”?

## LOCATION + CAPACITY

Our teams below are currently working on a multitude of projects within the state of Florida throughout various counties. The proposed personnel listed in the submittal shall be available and assigned to this project. We are able to begin working immediately on the project needs and the individuals in the submittal shall be available for tasks as assigned.

All elements of work will be provided in the state of Florida at each firms’ respective locations, listed below. Each firm will visit the site or attend meetings with the client as defined by the needs for this project.

### The Lunz Group - HQ

58 Lake Morton Drive  
Lakeland, Florida 33801  
Years in Operation: 37  
Employees: 22

### The Lunz Group Celebration

615 Celebration Ave  
Celebration, Florida 34747  
Years in Operation: 7  
Employees: 1

### Johnnie Lohrum (JL2)

1678 Kingston Road  
Longwood, FL 32750  
Years in Operation: 2  
Employees: 11

### Kimley-Horn & Associates

109 South Kentucky Avenue  
Lakeland, FL 33801  
Years in Operation: 56 Years  
Employees: 1,540 (FL) / 8,525 (Firmwide)  
*Kimley-Horn’s Lakeland, St. Petersburg, and Orlando office can be utilized to expedite a deliverable, if required.*

### TLC Engineering

4890 West Kennedy Blvd, #250  
Tampa, FL 33609  
Years in Operation: 69  
Employees: 500  
*TLC’s Tampa, Orlando, Melbourne, and Miami offices that can be utilized to expedite a deliverable, if required.*

### MES Group Inc.

550 North Reo Street, Suite 203  
Tampa, FL 33609  
Years in Operation: 25  
Employees: 22

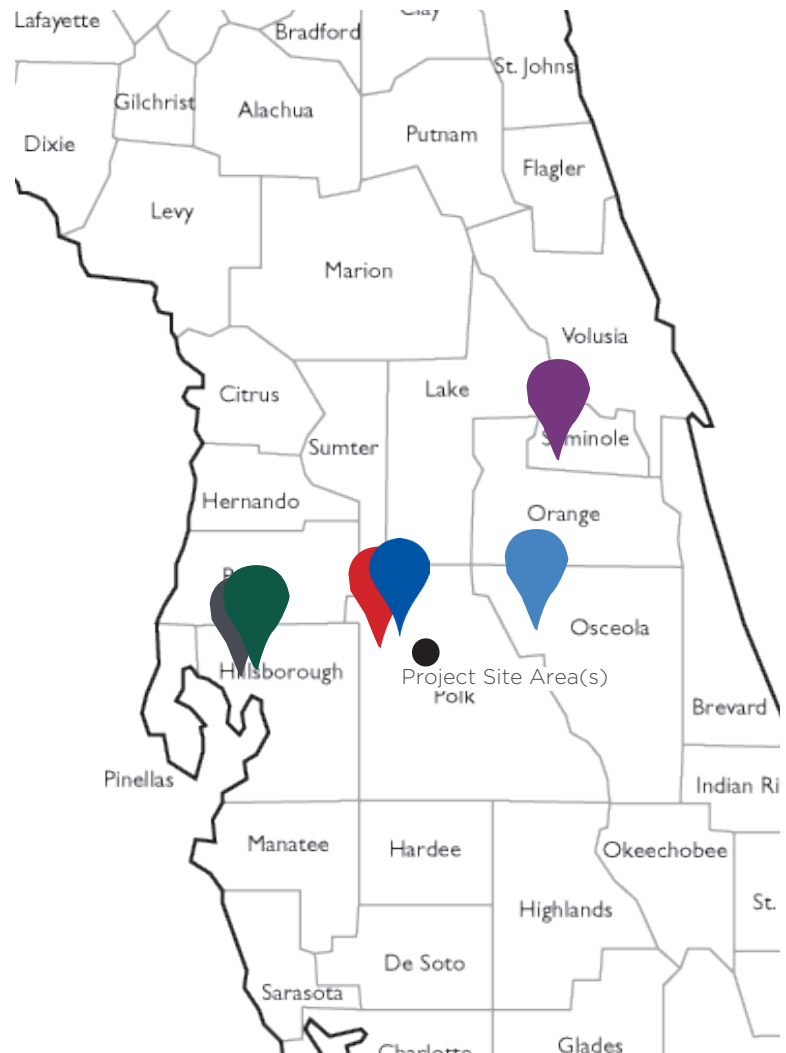

POLK COUNTY LOCAL BUSINESS TAX RECEIPT	
ACCOUNT NO. 59	CLASS: B+
EXPIRES: 09/30/2024	
OWNER NAME	LOCATION
BRADLEY T LUNZ	58 LAKE MORTON DR LAKELAND
BUSINESS NAME AND MAILING ADDRESS	CODE ACTIVITY TYPE
THE LUNZ GROUP 58 LAKE MORTON DR LAKELAND, FL 338015344	540810 ARCHITECT PROFESSIONAL LICENSE (IF APPLICABLE)
OFFICE OF JOE G. TEDDER, CFC * TAX COLLECTOR	THIS POLK COUNTY LOCAL BUSINESS TAX RECEIPT MUST BE DISPLAYED AT THE BUSINESS LOCATION
PAID - 1695537 08/14/2023 OPY OLP 57.75	THE LUNZ GROUP





# TAB 5

IS THE FIRM A “CERTIFIED  
WOMAN OR MINORITY BUSINESS  
ENTERPRISE”



# IS THE FIRM A “CERTIFIED WOMAN OR MINORITY BUSINESS ENTERPRISE”

The Lunz Group and its proposed subconsultants listed in this submittal are not Certified Woman or Minority Business Enterprises. However, The Lunz Group recognizes the importance of diversity and inclusion in today's business landscape and are dedicated to supporting and empowering underrepresented groups in our field. By embracing diversity in all its forms, we aim to contribute to a more equitable and inclusive economy, where every individual has the opportunity to thrive. We actively seek opportunities to collaborate with minority and women-owned businesses when possible; in this case, we would collaborate with Polk County to actively seek a MWBE certified GC/CMAR and/or work with the GC/CMAR to utilize local MWBE certified suppliers/vendors.



A photograph of the Folk County Sheriff's Office building, a two-story brick structure with a large glass entrance. The building is set against a clear blue sky. In the foreground, there is a parking lot and a landscaped area with rocks and small trees. A tall light pole stands to the right of the building. The text "FOLK COUNTY SHERIFF'S OFFICE" and "Northeast District Command" is visible on the building's facade.

# TAB 6

INTERACTION WITH COUNTY AND  
REGULATORY AGENCY STAFF



# INTERACTION WITH COUNTY AND REGULATORY STAFF

**INTERACTION WITH POLK COUNTY |** Our team's combined municipal experience in consultation, design, administration, permitting, governing regulations and construction phase services gives us the specific understanding of how to work with our regulatory agencies, facilities management, the sheriff's office, department divisions, elected officials and stakeholders, as well as the local community. Our attention to detail and ability to fast-track submission often means much less time in the permitting process – meaning a quicker project start-up for construction. Our decades of experience working with the County have provided us with the knowledge and understanding of working with Polk County facilities, elected officials and stakeholders and regulatory agencies in the County.

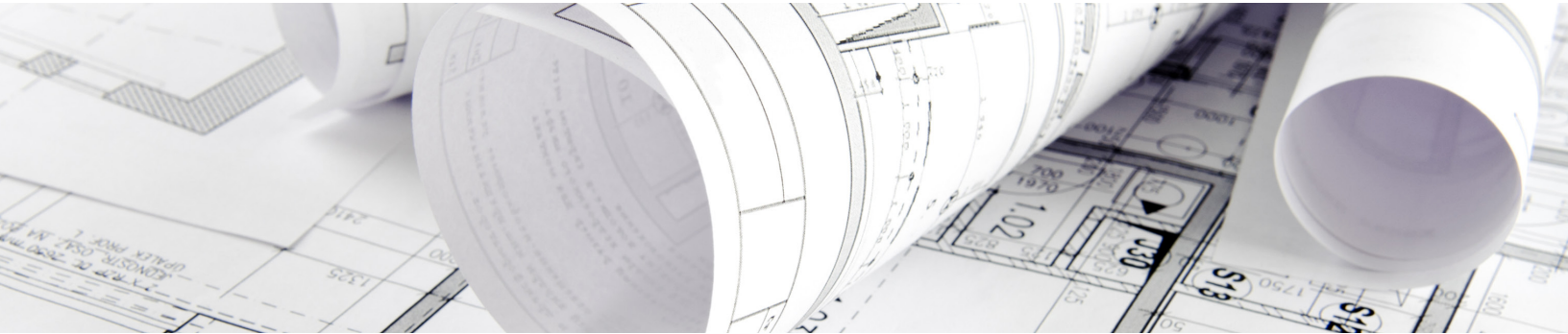

**EXPERIENCE WITH AGENCIES |** The Lunz Group's more than 30 year working relationship with Polk County has given us the knowledge and experience in working with our local regulatory agencies. Our team has the experience and working relationships within the County as it relates to the several aspects of a project, including permitting, construction, applications, consultation, governing regulations, SWFWMD and more. We consider ourselves to be an extension of the municipality's staff and are committed to the success of the projects we take on.







# TAB 7

TIMELY COMPLETION OF  
PROJECTS

# TIMELY COMPLETION OF PROJECTS

## CURRENT & FUTURE WORKLOAD

Built with a staff of more than 23 degreed professionals, The Lunz Group team includes five (5) licensed architects alongside additional staff composed of designers, technical personnel and a dedicated administrative staff. Our team also maintains additional certifications and professional affiliations beyond professional licensure including one (1) LEED AP and one (1) Registered Residential Contractor. Not only that, but our team members are invested in our communities as well, serving on various committees, community boards and chairing local organizations for numerous causes and community development efforts. With this level of staffing, we have the capability to successfully accommodate several projects simultaneously. Below is an estimated projected workload that is tentative and subject to change.

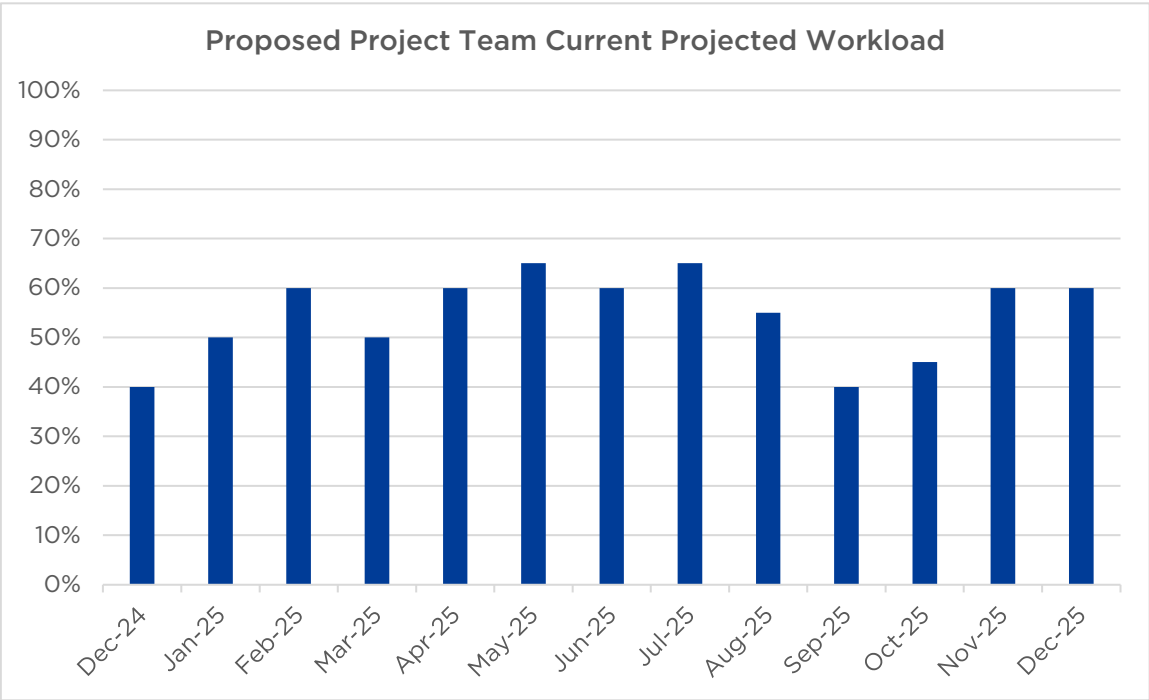

### KEY PERSONNEL ANTICIPATED AVAILABILITY

- Gregory Selvidge, Senior Project Manager | Anticipated 50% Availability
- Emily Breheny, Project Architect | Anticipated 70% Availability
- Trent Chamberlain, Senior Project Architect, QA | Anticipated 5% Availability
- Bradley T. Lunz, Principal In Charge | Anticipated 10% Availability
- Craig Fennig, Managing Director | Anticipated 5% Availability
- Production Staff Design Support | Anticipated 100% Availability

Our team meets regularly with our consultants to discuss the status of the project. The Project Manager conducts a weekly walk-through of tasks to be completed for the following week to ensure tasks are being managed and completed on schedule. Specifically, timeline schedule charts and budget analysis are discussed; near-term deliverables are defined. This process alerts the team to tasks that are pending or falling behind schedule so that steps can be planned to bring those tasks back to schedule compliance. Our Leadership team meets weekly for resource planning. During all phases of the project, our team tracks budget adherence and assures quality, to ensure the county is receiving an exceptional attention and all efforts are made to ensure expectations are met and there is a timely completion.





# TAB 8

SURVEYS OF PAST PERFORMANCE

# SURVEYS OF PAST PERFORMANCE

## Survey Questionnaire – Polk County

### RFP 24-643 Architectural and Engineering Services for Sheriff's Office – Polk County Joint-use Warehouse & Facilities Management Administration Building Architectural and Engineering Design

To: Steve McMillan (Name of Person completing survey)  
Polk County (Name of Client Company/Contractor)  
 Phone Number: 863.534.5511 Email: stevemcmillan@polk-county.net

Total Annual Budget of Entity \_\_\_\_\_

Subject: Past Performance Survey of Similar work:

Project name: Polk County Utilities Operations

Name of Vendor being surveyed: The Lunz Group

Cost of Services: Original Cost: \$423,000 Ending Cost: \$423,000

Contract Start Date: 2016 Contract End Date: 2018

Rate each of the criteria on a scale of 1 to 10, with 10 representing that you were very satisfied (and would hire the Consultant /individual again) and 1 representing that you were very unsatisfied (and would never hire the Consultant /individual again). Please rate each of the criteria to the best of your knowledge. If you do not have sufficient knowledge of past performance in a particular area, leave it blank.

NO	CRITERIA	UNIT	SCORE
1	Ability to manage cost	(1-10)	10
2	Ability to maintain project schedule (complete on-time/early)	(1-10)	10
3	Quality of workmanship	(1-10)	10
4	Professionalism and ability to manage	(1-10)	10
5	Close out process	(1-10)	10
6	Ability to communicate with Client's staff	(1-10)	10
7	Ability to resolve issues promptly	(1-10)	10
8	Ability to follow protocol	(1-10)	10
9	Ability to maintain proper documentation	(1-10)	10
10	Appropriate application of technology	(1-10)	10
11	Overall Client satisfaction and comfort level in hiring	(1-10)	10
12	Ability to offer solid recommendations	(1-10)	10
13	Ability to facilitate consensus and commitment to the plan of action among staff	(1-10)	10

Printed Name of Evaluator Steve McMillan

Signature of Evaluator: 

Please fax or email the completed survey to: marketing@lunz.com

# SURVEYS OF PAST PERFORMANCE

## Survey Questionnaire – Polk County

### RFP 24-643 Architectural and Engineering Services for Sheriff's Office – Polk County Joint-use Warehouse & Facilities Management Administration Building Architectural and Engineering Design

To: Steve McMillan (Name of Person completing survey)  
Polk County (Name of Client Company/Contractor)  
Phone Number: 863.534.5511 Email: stevemcmillan@polk-county.net

Total Annual Budget of Entity \_\_\_\_\_

Subject: Past Performance Survey of Similar work:

Project name: Polk County Roads & Drainage Office Annex

Name of Vendor being surveyed: The Lunz Group

Cost of Services: Original Cost: \$275,000 Ending Cost: \$275,000

Contract Start Date: 2018 Contract End Date: 2020

Rate each of the criteria on a scale of 1 to 10, with 10 representing that you were very satisfied (and would hire the Consultant /individual again) and 1 representing that you were very unsatisfied (and would never hire the Consultant /individual again). Please rate each of the criteria to the best of your knowledge. If you do not have sufficient knowledge of past performance in a particular area, leave it blank.

NO	CRITERIA	UNIT	SCORE
1	Ability to manage cost	(1-10)	10
2	Ability to maintain project schedule (complete on-time/early)	(1-10)	10
3	Quality of workmanship	(1-10)	10
4	Professionalism and ability to manage	(1-10)	10
5	Close out process	(1-10)	10
6	Ability to communicate with Client's staff	(1-10)	10
7	Ability to resolve issues promptly	(1-10)	10
8	Ability to follow protocol	(1-10)	10
9	Ability to maintain proper documentation	(1-10)	10
10	Appropriate application of technology	(1-10)	10
11	Overall Client satisfaction and comfort level in hiring	(1-10)	10
12	Ability to offer solid recommendations	(1-10)	10
13	Ability to facilitate consensus and commitment to the plan of action among staff	(1-10)	10

Printed Name of Evaluator Steve McMillan

Signature of Evaluator: 

Please fax or email the completed survey to: marketing@lunz.com



# SURVEYS OF PAST PERFORMANCE

## Survey Questionnaire – Polk County

### RFP 24-643 Architectural and Engineering Services for Sheriff's Office – Polk County Joint-use Warehouse & Facilities Management Administration Building Architectural and Engineering Design

To: Steve McMillan \_\_\_\_\_ (Name of Person completing survey)

Polk County Sheriff's Office / Polk County \_\_\_\_\_ (Name of Client Company/Contractor)

Phone Number: 863-534-5527

Email: [stevemcmillan@polk-county.net](mailto:stevemcmillan@polk-county.net)

Total Annual Budget of Entity \$8,100,000.00 - CIP Project Budget

Subject: Past Performance Survey of Similar work:

Project name: Polk County Sheriff's Burnham-McCall Training Center

Name of Vendor being surveyed: The Lunz Group

Cost of Services: Original Cost: \$586,708.00 Ending Cost: \$586,708.00

Contract Start Date: 2021 Contract End Date: 2024

Rate each of the criteria on a scale of 1 to 10, with 10 representing that you were very satisfied (and would hire the Consultant /individual again) and 1 representing that you were very unsatisfied (and would never hire the Consultant /individual again). Please rate each of the criteria to the best of your knowledge. If you do not have sufficient knowledge of past performance in a particular area, leave it blank.

NO	CRITERIA	UNIT	SCORE
1	Ability to manage cost	(1-10)	10
2	Ability to maintain project schedule (complete on-time/early)	(1-10)	10
3	Quality of workmanship	(1-10)	10
4	Professionalism and ability to manage	(1-10)	10
5	Close out process	(1-10)	10
6	Ability to communicate with Client's staff	(1-10)	10
7	Ability to resolve issues promptly	(1-10)	10
8	Ability to follow protocol	(1-10)	10
9	Ability to maintain proper documentation	(1-10)	10
10	Appropriate application of technology	(1-10)	10
11	Overall Client satisfaction and comfort level in hiring	(1-10)	10
12	Ability to offer solid recommendations	(1-10)	10
13	Ability to facilitate consensus and commitment to the plan of action among staff	(1-10)	10

Printed Name of Evaluator Steve McMillan

Signature of Evaluator: Steve McMillan

Please fax or email the completed survey to: marketing@lunz.com

# SURVEYS OF PAST PERFORMANCE

## Survey Questionnaire – Polk County

### RFP 24-643 Architectural and Engineering Services for Sheriff's Office – Polk County Joint-use Warehouse & Facilities Management Administration Building Architectural and Engineering Design

To: Hye (Jay) Kwag (Name of Person completing survey)

City of Plant City (Name of Client Company/Contractor)

Phone Number: 813.365.4929 Email: hkwag@plantcitygov.com

Total Annual Budget of Entity \_\_\_\_\_

Subject: Past Performance Survey of Similar work:

Project name: Utilities and Solid Waste Department Facility

Name of Vendor being surveyed: The Lunz Group

Cost of Services: Original Cost: 290,550 Ending Cost: TBD

Contract Start Date: November 2023 Contract End Date: Est. February 2025

**Rate each of the criteria on a scale of 1 to 10, with 10 representing that you were very satisfied (and would hire the Consultant /individual again) and 1 representing that you were very unsatisfied (and would never hire the Consultant /individual again). Please rate each of the criteria to the best of your knowledge. If you do not have sufficient knowledge of past performance in a particular area, leave it blank.**

NO	CRITERIA	UNIT	SCORE
1	Ability to manage cost	(1-10)	9
2	Ability to maintain project schedule (complete on-time/early)	(1-10)	9
3	Quality of workmanship	(1-10)	10
4	Professionalism and ability to manage	(1-10)	10
5	Close out process	(1-10)	NA
6	Ability to communicate with Client's staff	(1-10)	10
7	Ability to resolve issues promptly	(1-10)	10
8	Ability to follow protocol	(1-10)	10
9	Ability to maintain proper documentation	(1-10)	9
10	Appropriate application of technology	(1-10)	9
11	Overall Client satisfaction and comfort level in hiring	(1-10)	10
12	Ability to offer solid recommendations	(1-10)	10
13	Ability to facilitate consensus and commitment to the plan of action among staff	(1-10)	9

Printed Name of Evaluator Hye (Jay) Kwag

Signature of Evaluator: 

Please fax or email the completed survey to: marketing@lunz.com



# TAB 9

ADDENDA  
ACKNOWLEDGMENTS



# ADDENDA **ACKNOWLEDGMENTS**

October 31, 2024

## **POLK COUNTY, A POLITICAL SUBDIVISION OF THE STATE OF FLORIDA**

### **ADDENDUM #1**

#### **RFP 24-643, Architectural & Engineering Services for Sheriff's Office - Polk County Joint-use Warehouse & Facilities Management Administration Building**

---

This addendum is issued to clarify, add to, revise and/or delete items of the RFP Documents for this work. This Addendum is a part of the RFP Documents and acknowledgment of its receipt should be noted on the Addendum.

---

Contained within this addendum: Questions/answers and clarification.

*Tabatha Shirah*

Tabatha Shirah

Procurement Analyst

Procurement Division

---

**This Addendum sheet should be signed and returned with your submittal. This is the only acknowledgment required.**

Signature: \_\_\_\_\_

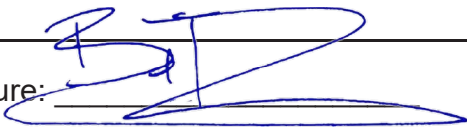

Printed Name: Bradley T. Lunz

Title: President and CEO

Company: The Lunz Group

# ADDENDA **ACKNOWLEDGMENTS**

November 6, 2024

## **POLK COUNTY, A POLITICAL SUBDIVISION OF THE STATE OF FLORIDA**

### **ADDENDUM # 2**

#### **RFP 24-643, Architectural & Engineering Services for Sheriff's Office - Polk County Joint-use Warehouse & Facilities Management Administration Building**

---

This addendum is issued to clarify, add to, revise and/or delete items of the RFP Documents for this work. This Addendum is a part of the RFP Documents and acknowledgment of its receipt should be noted on the Addendum.

---

Contained within this addendum: Questions/answers.

*Tabatha Shirah*

Tabatha Shirah

Procurement Analyst

Procurement Division

---

**This Addendum sheet should be signed and returned with your submittal. This is the only acknowledgment required.**

---

Signature: 

Printed Name: Bradley T. Lunz

Title: President and CEO

Company: The Lunz Group



# ADDENDA **ACKNOWLEDGMENTS**

November 12, 2024

## **POLK COUNTY, A POLITICAL SUBDIVISION OF THE STATE OF FLORIDA**

### **ADDENDUM #3**

#### **RFP 24-643, Architectural & Engineering Services for Sheriff's Office - Polk County Joint-use Warehouse & Facilities Management Administration Building**

---

This addendum is issued to clarify, add to, revise and/or delete items of the RFP Documents for this work. This Addendum is a part of the RFP Documents and acknowledgment of its receipt should be noted on the Addendum.

---

Contained within this addendum: Questions/answers.

*Tabatha Shirah*

Tabatha Shirah

Procurement Analyst

Procurement Division

---

**This Addendum sheet should be signed and returned with your submittal. This is the only acknowledgment required.**

Signature: \_\_\_\_\_

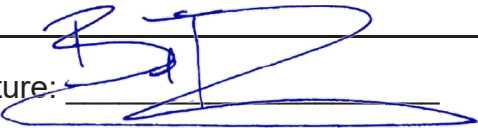

Printed Name: Bradley T. Lunz

Title: President and CEO

Company: The Lunz Group