

ENGINEERING NOTES:

1. ENGINEERING MEETS OR EXCEEDS 2023 FLORIDA BUILDING CODE (8th EDITION), RESIDENTIAL, PER SECTION R301 USING ASCE-7-22 130 mph BASIC WIND SPEED (Vult). RISK CATEGORY I, $V_{asd} = 101$ MPH.

2. EXPOSURE C

INTERNAL PRESSURE COEFFICIENT = ± 0.55

3. ALL ALUMINUM MEMBERS TO BE 6005 T5 OR 6063 T6 BASED ON AVAILABILITY WITH MINIMUM 0.04 INCH THICKNESS.

MD Construction LLC
6656 SR 544, Winter Haven, FL 33881
Office: (321) 663-5203
email: mdconstructionfl@gmail.com
Licensed & Insured
State Certified Specialty Contractor
SCC1311151708



OWNER
Indarjit Jialal
Phone: 570-972-9003
Address: 450 Cinnamon Dr
Poinciana - FL 34759

PAGE 1 OF 4

Lildon Engineering Company
548-B South Highway 27
Minneola, Florida 34715
(352) 394-2590
lildonengineering@gmail.com
Cert. of Auth. #2898

January 21, 2025
Ryan G. Workman PE # 91950

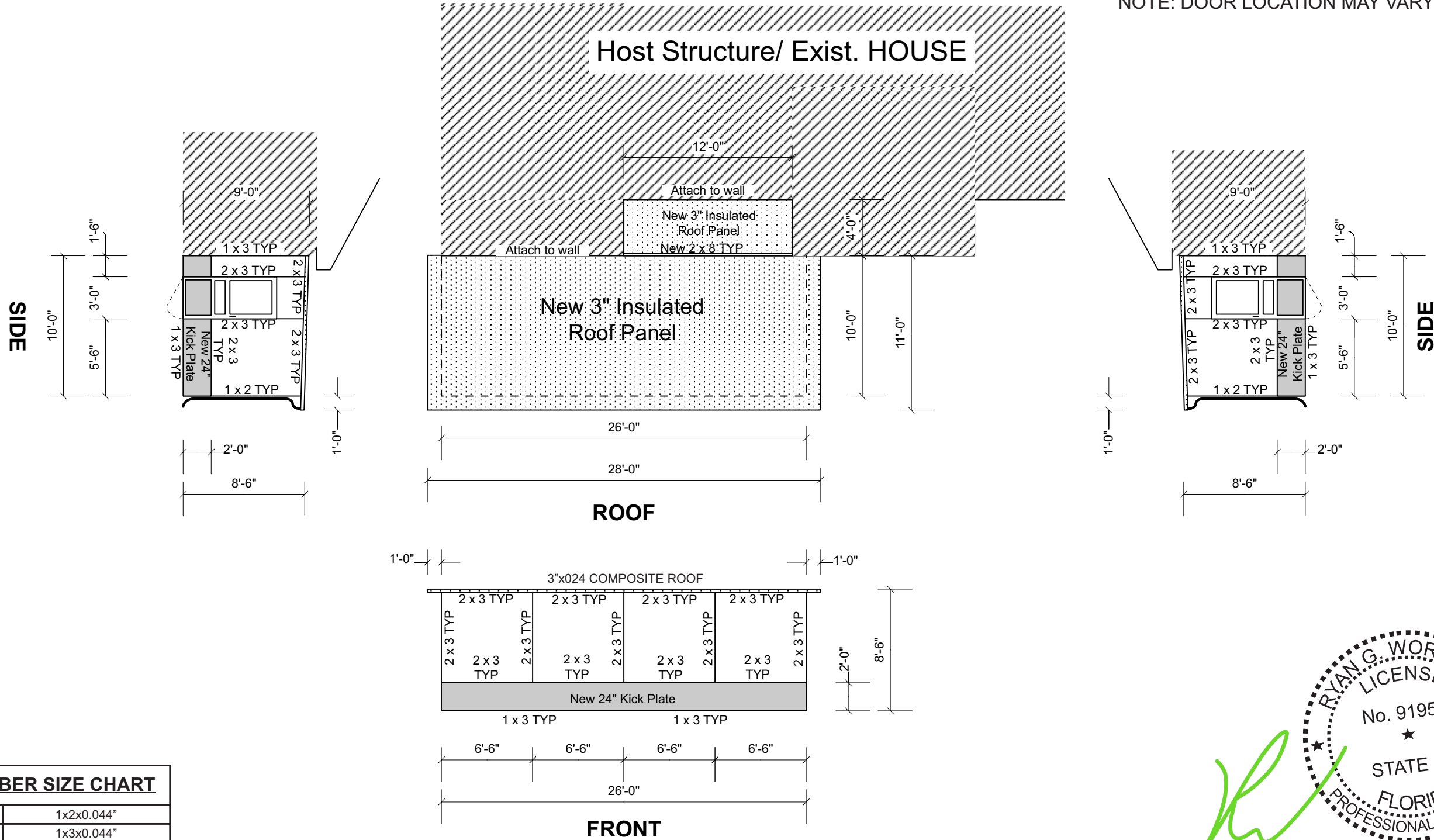

1x2	1x2x0.044"
1x3	1x3x0.044"
2x2	2x2x0.045"
2x3	2x3x0.045"
2x6	2x8x0.072" SMB
3x3	3x3x0.090"

This item has been digitally signed and sealed
by Ryan G. Workman, PE #91950 on the date
adjacent to the seal. Printed copies of this document
are not considered signed and sealed and the signature
must be verified on any electronic copies.

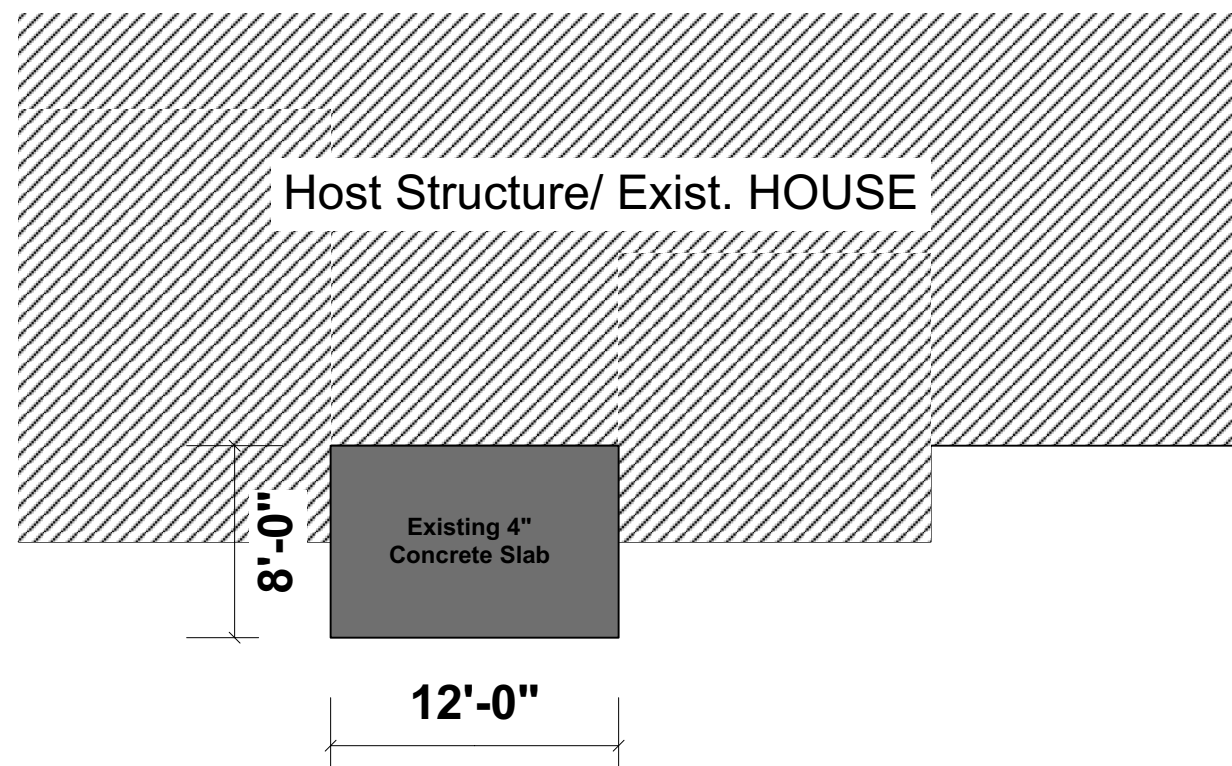

EXISTING FOUNDATION

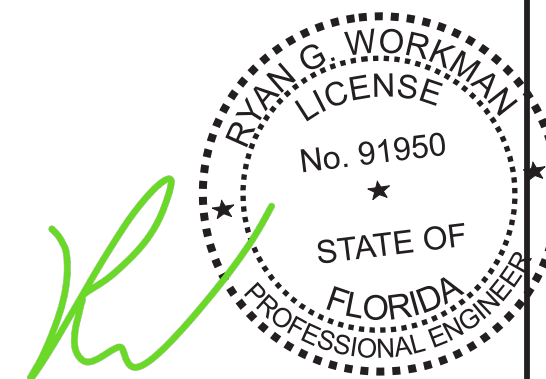

This item has been digitally signed and sealed by Ryan G. Workman, PE #91950 on the date adjacent to the seal. Printed copies of this document are not considered signed and sealed and the signature must be verified on any electronic copies.

MD Construction LLC
6656 SR 544, Winter Haven, FL 33881
Office: (321) 663-5203
email: mdconstructionfl@gmail.com
Licensed & Insured
State Certified Specialty Contractor
SCC131151708



OWNER
Indarjit Jailal
Phone: 570-972-9003
Address: 450 Cinnamon Dr
Poinciana - FL 34759

PAGE 2 OF 4

Lildon Engineering Company
548-B South Highway 27
Minneola, Florida 34715
(352) 394-2590
lildonengineering@gmail.com
Cert. of Auth. #2898

January 21, 2025
Ryan G. Workman PE # 91950

CONCRETE FOOTING NOTES

1. SLAB AND FOOTINGS: 2500 psi (MIN.)
2. REINFORCEMENT: #5 Bar Grade 40 in footings with 25" minimum splice lap. See details on plans to see if/where rebar is required.
3. REBAR COVERAGE: All rebar in footings to have 3" minimum coverage of concrete.
4. DRAINAGE: Finish Grade to provide positive drainage away from structure to city/counties requirements.
5. SOIL PRESSURE: Soil pressure must provide 2000 psf bearing minimum. Consult Engineer of Record if soil pressure does not meet or exceed 2000 psf.

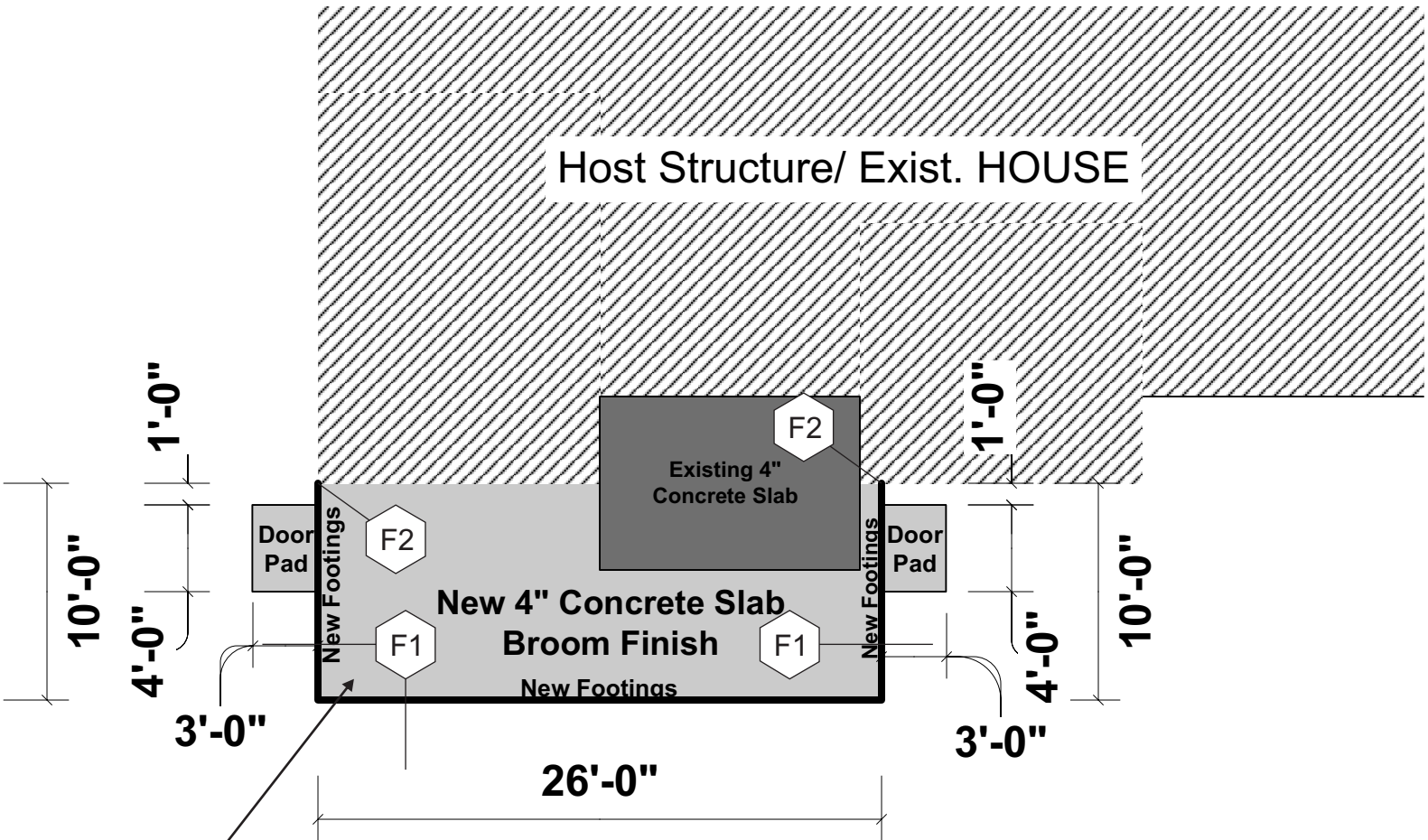

NEW SLAB: 4" CONCRETE, 2500 psi (MIN.) WITH FIBERMESH OR 6x6 #10 WWM OVER CLEAN SOIL. SLOPE CONCRETE 1% MIN. AWAY FROM EXISTING STRUCTURE. VAPOR BARRIER AND TERMITE TREATMENT REQUIRED WITHIN 12" OF EXISTING RESIDENCE.

NEW FOUNDATION

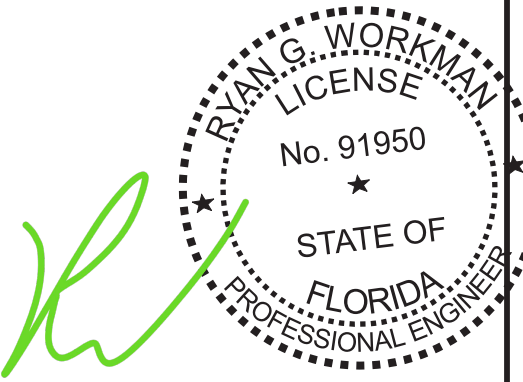
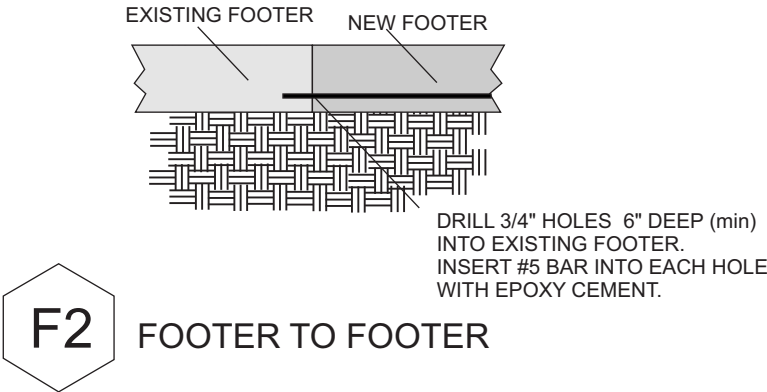
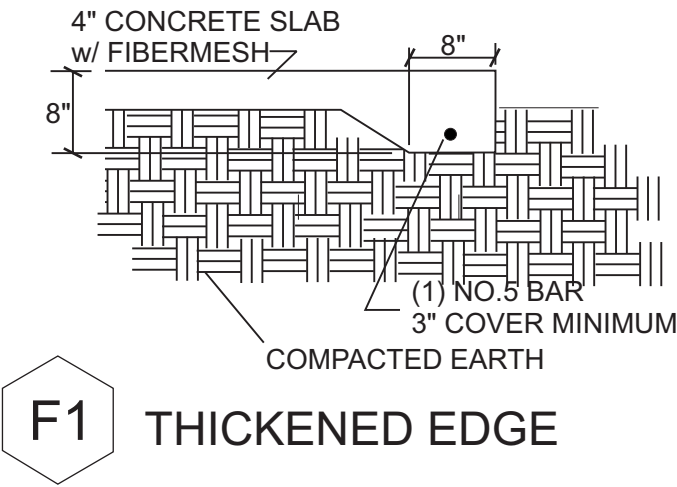

This item has been digitally signed and sealed by Ryan G. Workman, PE #91950 on the date adjacent to the seal. Printed copies of this document are not considered signed and sealed and the signature must be verified on any electronic copies.

MD Construction LLC
6656 SR 544, Winter Haven, FL 33881
Office: (321) 663-5203
email: mdconstructionfl@gmail.com
Licensed & Insured
State Certified Specialty Contractor
SCC131151708



OWNER

Indarjit Jaijal
Phone: 570-972-9003
Address: 450 Cinnamon Dr
Poinciana - FL 34759

PAGE 3 OF 4

Lildon Engineering Company
548-B South Highway 27
Minneola, Florida 34715
(352) 394-2590
lildonengineering@gmail.com
Cert. of Auth. #2898

January 21, 2025
Ryan G. Workman PE # 91950

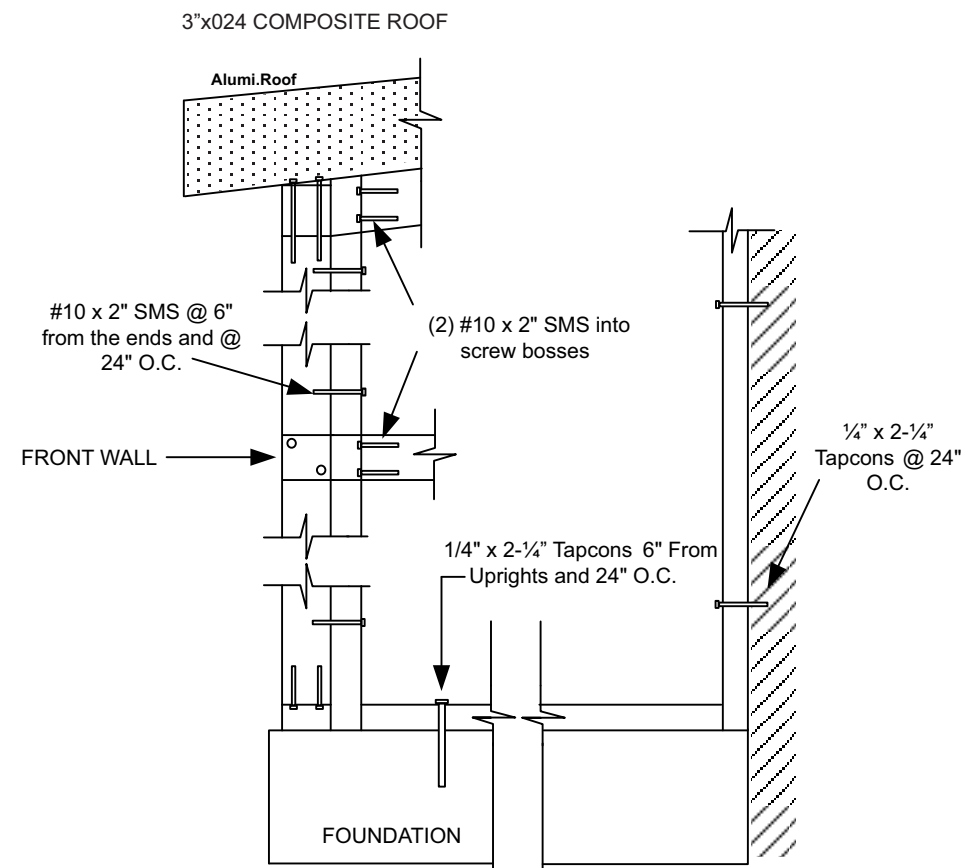

TYPICAL SIDE DETAIL

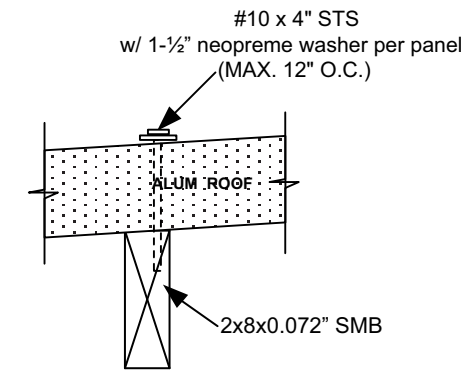

ALUM. ROOF DETAIL

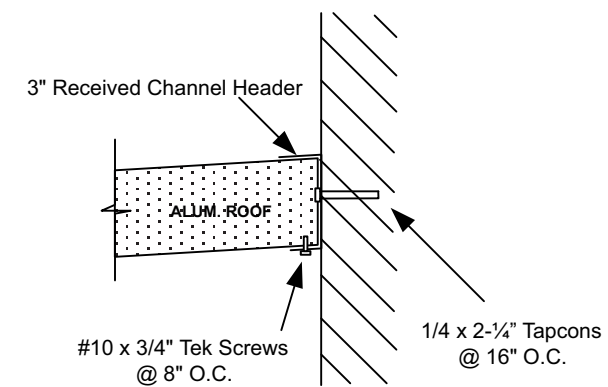

ALUM. ROOF TO WALL

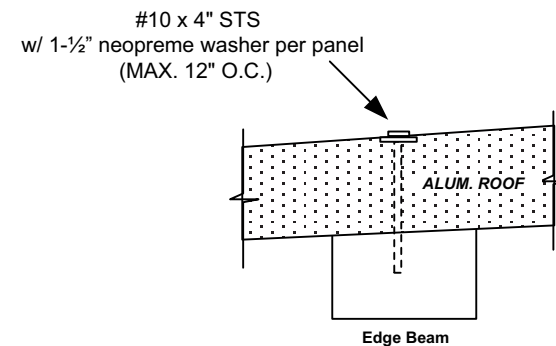

TYPICAL ROOF TO BEAM DETAIL

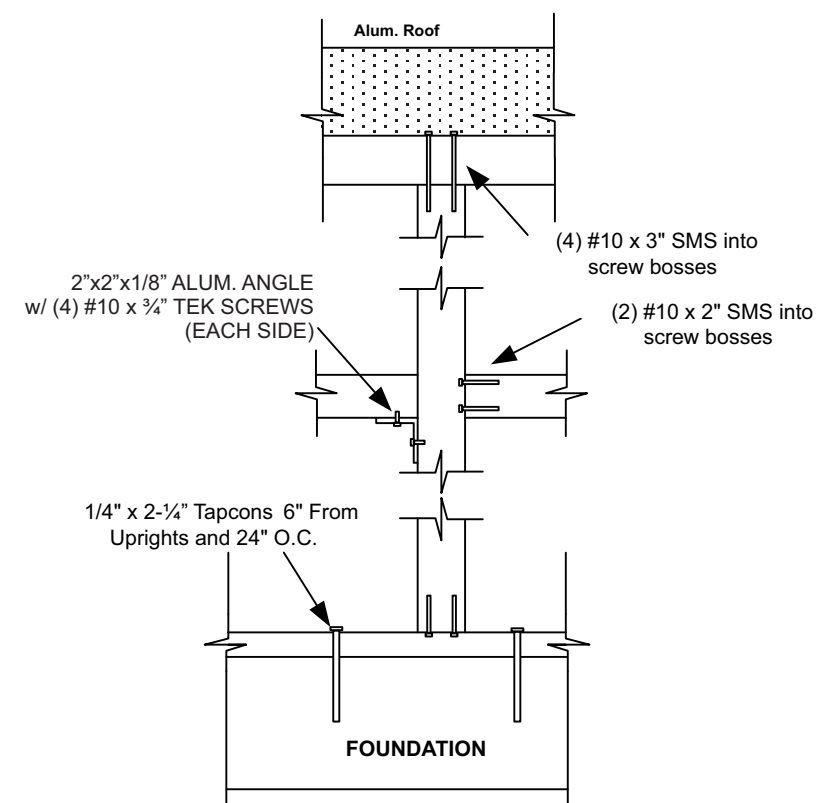

TYPICAL UPRIGHT DETAIL

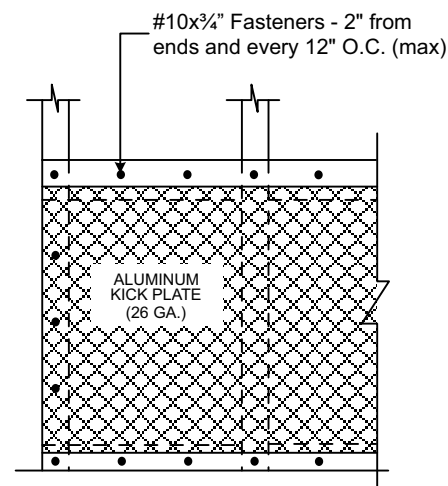

TYPICAL ALUMINUM KICK PLATE ATTACHMENT

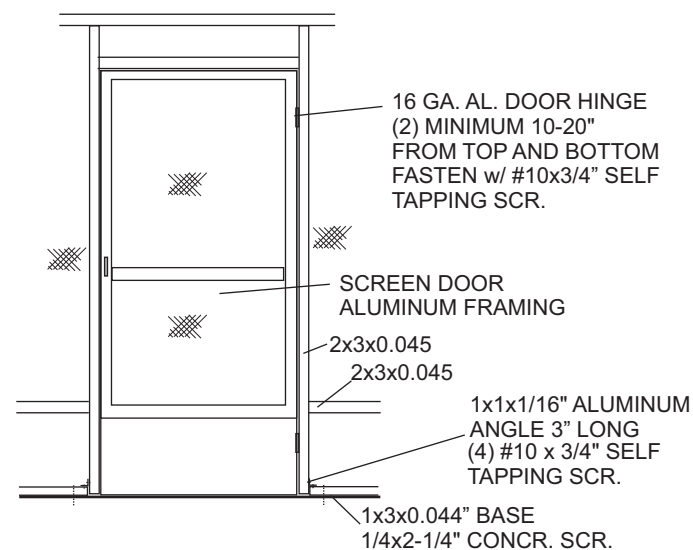

TYPICAL SCREEN DOOR CONNECTION DETAIL

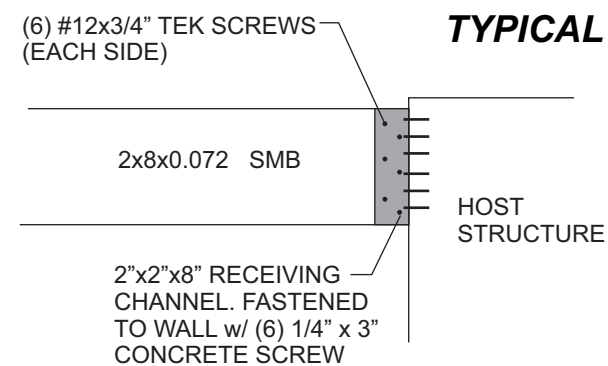

BEAM TO WALL

*NOTE: IF FASTENING THROUGH PAVERS USE 1/4"x5" TAPCONS (1-1/2" MIN EMBEDMENT).

MD Construction LLC
6656 SR 544, Winter Haven, FL 33881
Office: (321) 663-5203
email: mdconstructionllc@gmail.com
Licensed & Insured
State Certified Specialty Contractor
SCC131151708



OWNER
Indarjit Jaiial
Phone: 570-972-9003
Address: 450 Cinnamon Dr
Poinciana - FL 34759

PAGE 4 OF 4

Lildon Engineering Company
548-B South Highway 27
Minneola, Florida 34715
(352) 394-2590
lildonengineering@gmail.com
Cert. of Auth. #2898

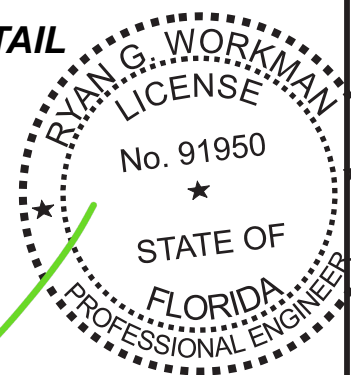

This item has been digitally signed and sealed by Ryan G. Workman, PE #91950 on the date adjacent to the seal. Printed copies of this document are not considered signed and sealed and the signature must be verified on any electronic copies.

January 21, 2025
Ryan G. Workman PE # 91950