

### GENERAL LUMBERS NOTES

1. ALL LUMBERS TO BE SOUTHERN YELLOW PINE NO. 2 OR PRUCE NO. WITH MAX. CONTENT OR MOISTURE 19% LUMBER IN CONTACT W/ CONCRETE TO BE PRESSURE TREATED. STUDS MAY BE SPF STUDS GRADE.
2. ALL EXTERIOR DOORS & WINDOWS TO GARAGE MUST BE SOLIDE WOOD & MIN. THICKNESS OF 1 3/8" OR SOLID CORE METAL.
3. PROVIDE ADEQUATE BRACING & BRIDGING TO TRUSSES TO RESIST WIND & OTHER LATERAL FORCES.
4. ALL TOP PLATE SPLICES SHALL BE
5. ALL GIRDERS & GANGED MEMBERS SHALL HAVE AN EQUAL NUMBER OF GANGED STUDS IN SUPPORT OF THE MEMBERS.
6. BOTTOM OF ALL EXTERIOR SHEATHING SHALL BE AT LEAST 6 1/2" ABOVE GRADE.

Design Right/Schiller Mercier  
1215 N PINE HILLS RD  
ORLANDO, FL 32808

House Interior Renovation and Front Renovation  
for:  
KNA Real Estate Investments LLC  
1210 33RD ST NW  
Winter Haven, Florida 33881

### NOTES

1. WOOD STUD SPACING: (UNLESS OTHERWISE NOTED ON PLANS)  
-EXTERIOR FRAME WALLS AT 16" O.C.  
-INTERIOR FRAME BRG. WALLS AT 16" O.C  
-INTERIOR FRAME NON-BRG. WALLS AT 24" O.C  
-KITCHEN CABINET WALLS AT 16" O.C.
2. FRAME WALLS ARE DRAWING 3 1/2" WIDE UNLESS OTHERWISE NOTED
3. CONCRETE WALLS BLOCK ARE DRAWN 7 5/8" UNLESS OTHERWISE NOTED
4. TOOL CONCRETE BLOCK JOINTS INSIDE GARAGE WALLS (BRUSH & CLEAN)
5. DOOR & WINDOW ROUGH OPENINGS SHALL BE PROVIDED BY BUILDER
6. TOP OF TYP. BEARING WALL +8'-0" UNLESS OTHERWISE NOTED
7. HEIGHTS ARE MEASURED ABOVE TOP OF FOYER SLAB
8. SEE STRUCTURAL NOTES FOR ADDITIONAL INFORMATION.

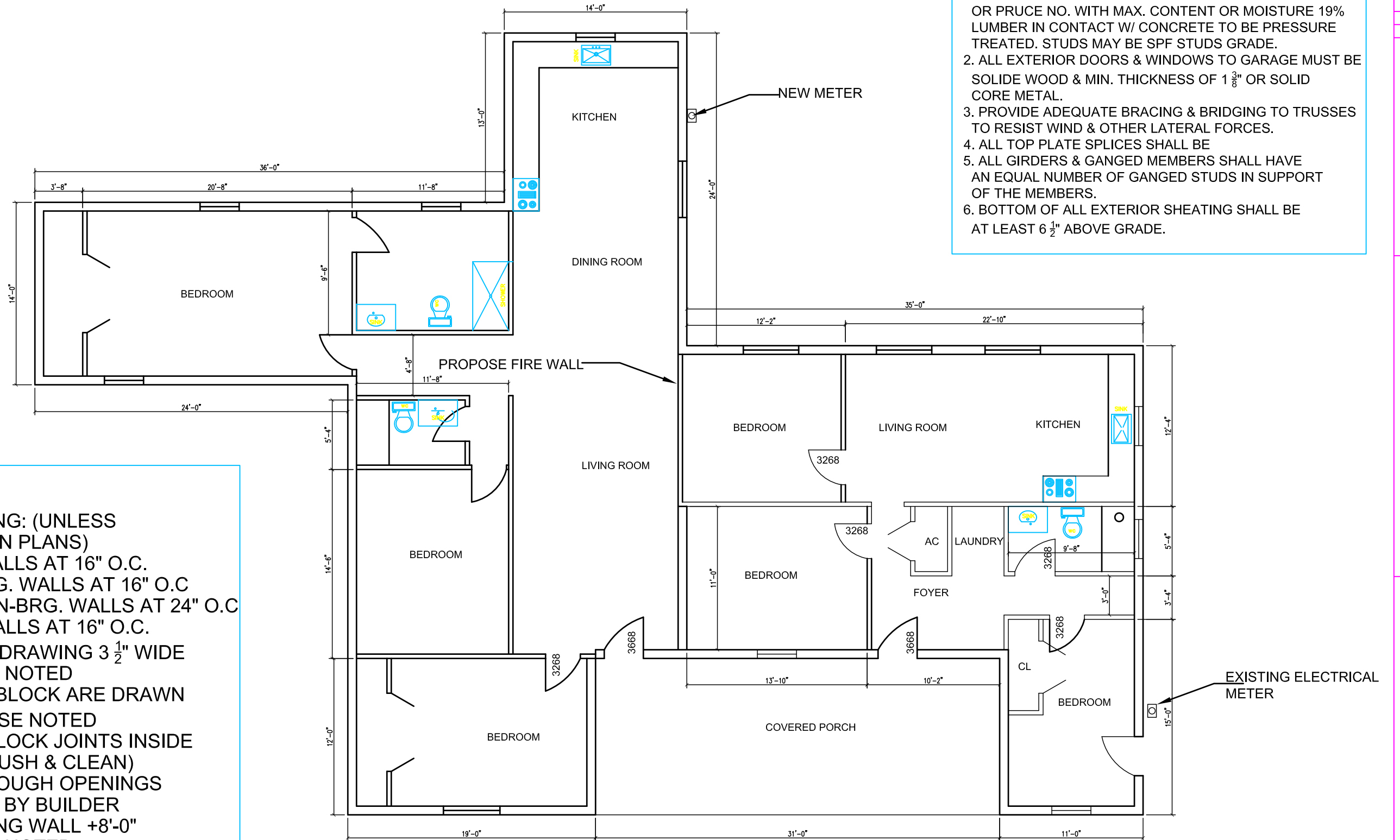

**Proposed Duplex Floor Plan**  
Scale: 1/8"=1'-0"