

Section 22, Township 28 South, Range 24 East

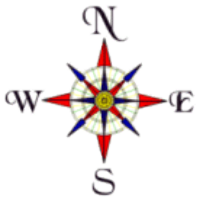

SECTION 22, TOWNSHIP 28 SOUTH, RANGE 24 EAST

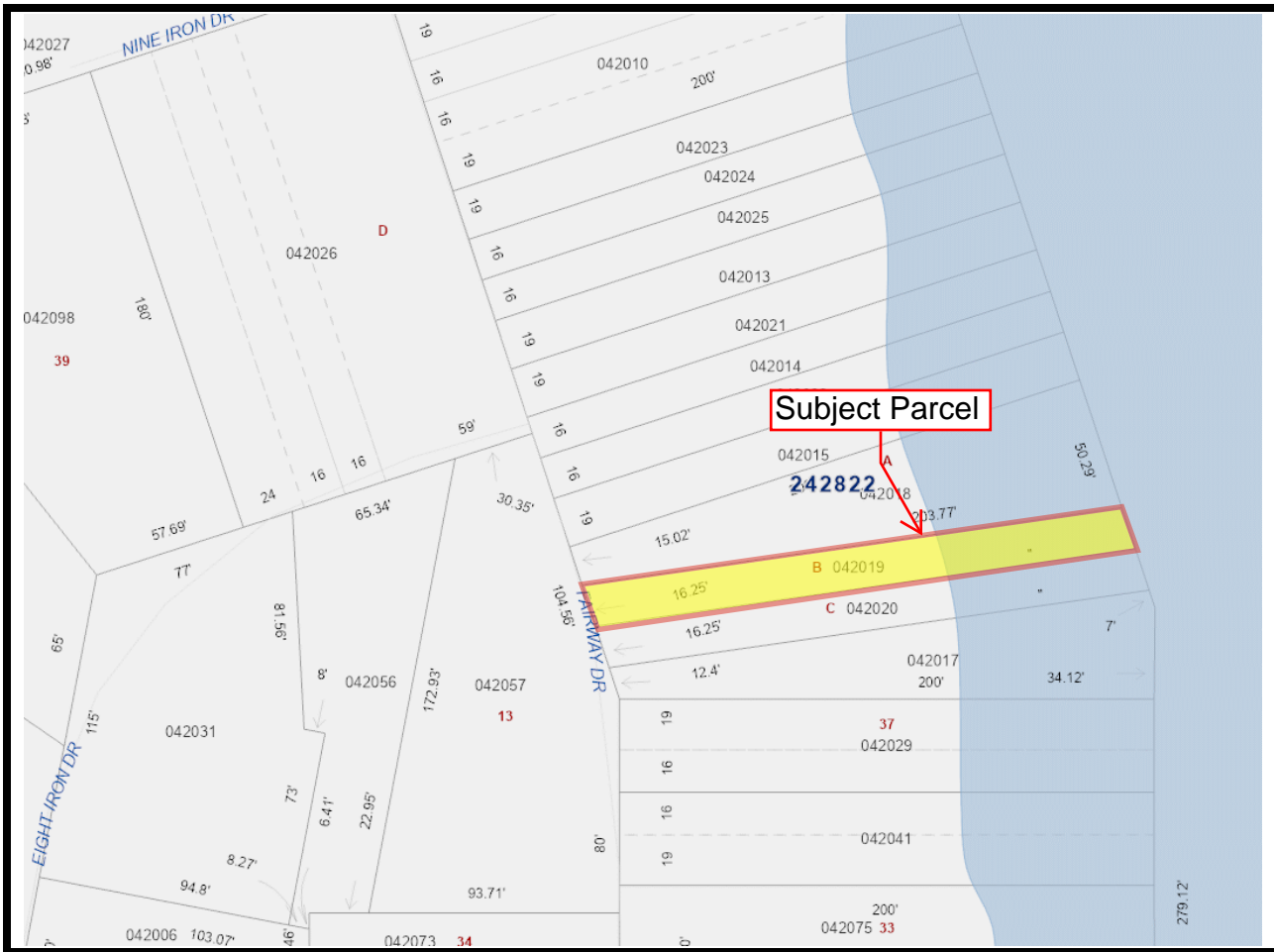

This instrument prepared under  
The direction of:  
R. Wade Allen, Director  
Polk County Real Estate Services  
P. O. Box 9005, Drawer RE 01  
Bartow, Florida 33831-9005  
By: Heather Fuentes *scj cp*  
Parcel I.D. No.: 242822-000000-042019

**COUNTY DEED**

**THIS DEED** made this 1st day of April 2025, by **POLK COUNTY**, a political subdivision of the State of Florida, Grantor, to **HULBERT HOMES, INC.**, a Florida corporation, whose address is P.O. Box 6254, Lakeland, Florida 33807, Grantee.

**WITNESSETH:** That the Grantor, for and in consideration of the sum of \$1.00, to it in hand paid by the Grantee, receipt whereof is hereby acknowledged, has granted, bargained, and sold to Grantee, its successors and assigns forever, all the right, title, interest, including interests, if any, in rights which may have been reserved by operation of Section 270.11 Florida Statutes, claim, and demand, which the Grantor has in and to the following described land lying and being in Polk County, Florida, to wit:

**Commence at the Southwest corner of the Southeast 1/4 of the Southwest 1/4 of Section 22, Township 28 South, Range 24 East; thence run East 1051.31 feet; thence run North 45°00'00" West 470.00 feet; thence run North 330.00 feet; thence run North 18°09'30" West 28.73 feet to the Point of Beginning; thence run North 18°09'30" West 16.25 feet; thence run North 81°50'30" East 203.77 feet; thence run South 18°09'30" East 16.25 feet; thence run South 81°50'30" West 203.77 feet to the Point of Beginning. Being Lot 38B of unrecorded survey. All lying and being in Section 22, Township 28 South, Range 24 East, Polk County, Florida.**

Being the same property described in that certain Escheatment Tax Deed recorded in Official Records Book 07116 at Page 1488, Public Records of Polk County, Florida.

**IN WITNESS WHEREOF**, said Grantor has caused these presents to be executed in its name by its Board of County Commissioners, acting by the Chair or Vice-Chair of said board, the day and year aforesaid.

**ATTEST:**  
**Stacy M. Butterfield**  
**Clerk to the Board**

**GRANTOR:**  
**Polk County, Florida, a political**  
**subdivision of the state of Florida**

By: \_\_\_\_\_  
**Deputy Clerk**  
(Seal)

By: \_\_\_\_\_  
**T.R. Wilson, Chairman**  
**Board of County Commissioners**