

North

Subject Locations

Sections 05 & 27, Township 31 South, Range 31 East

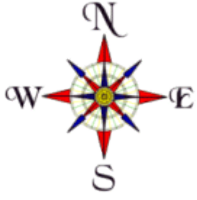

SECTION 05, TOWNSHIP 31 SOUTH, RANGE 31 EAST

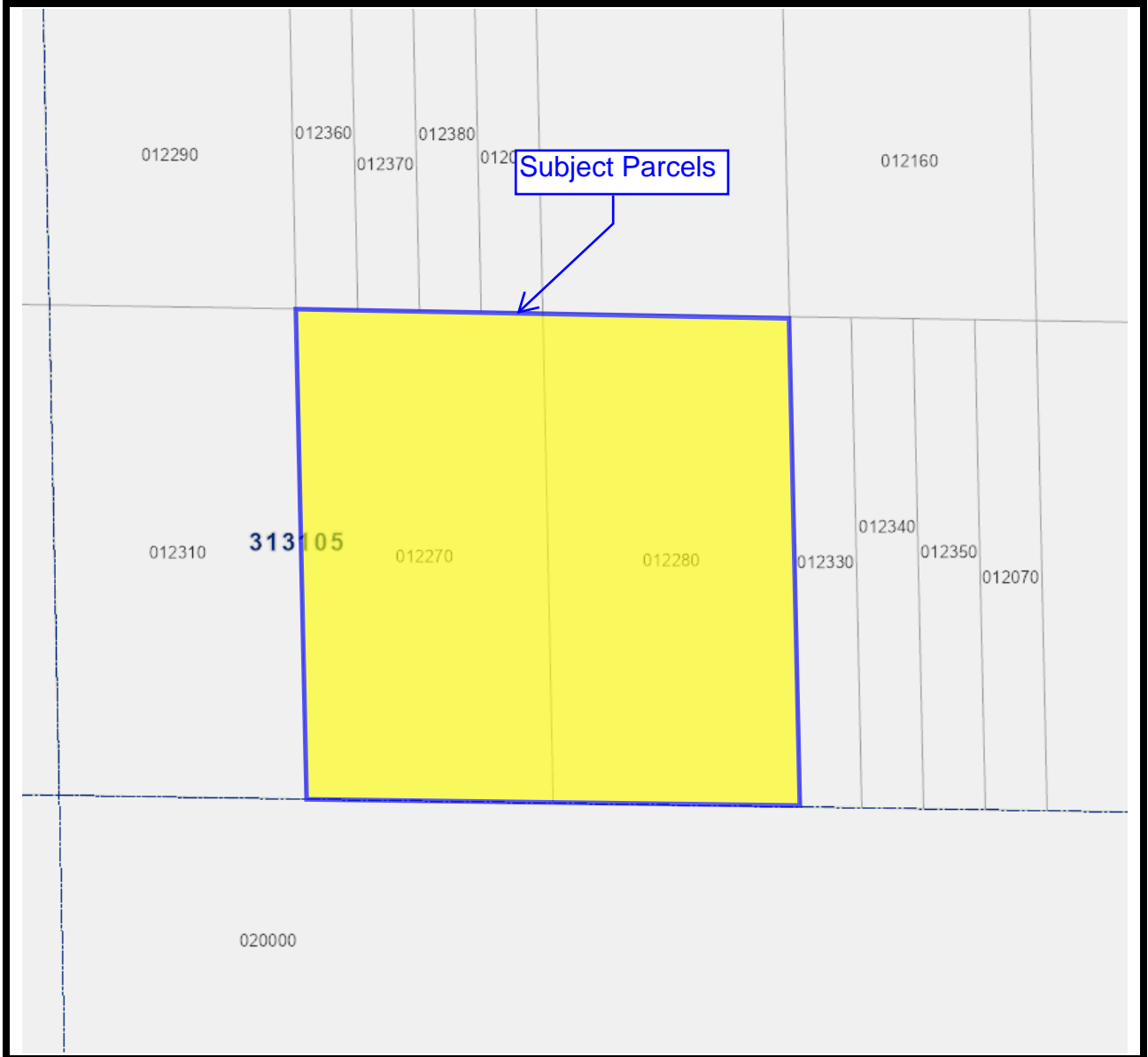

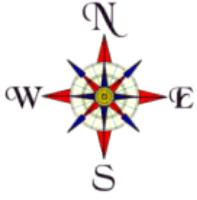

SECTION 27, TOWNSHIP 31 SOUTH, RANGE 31 EAST

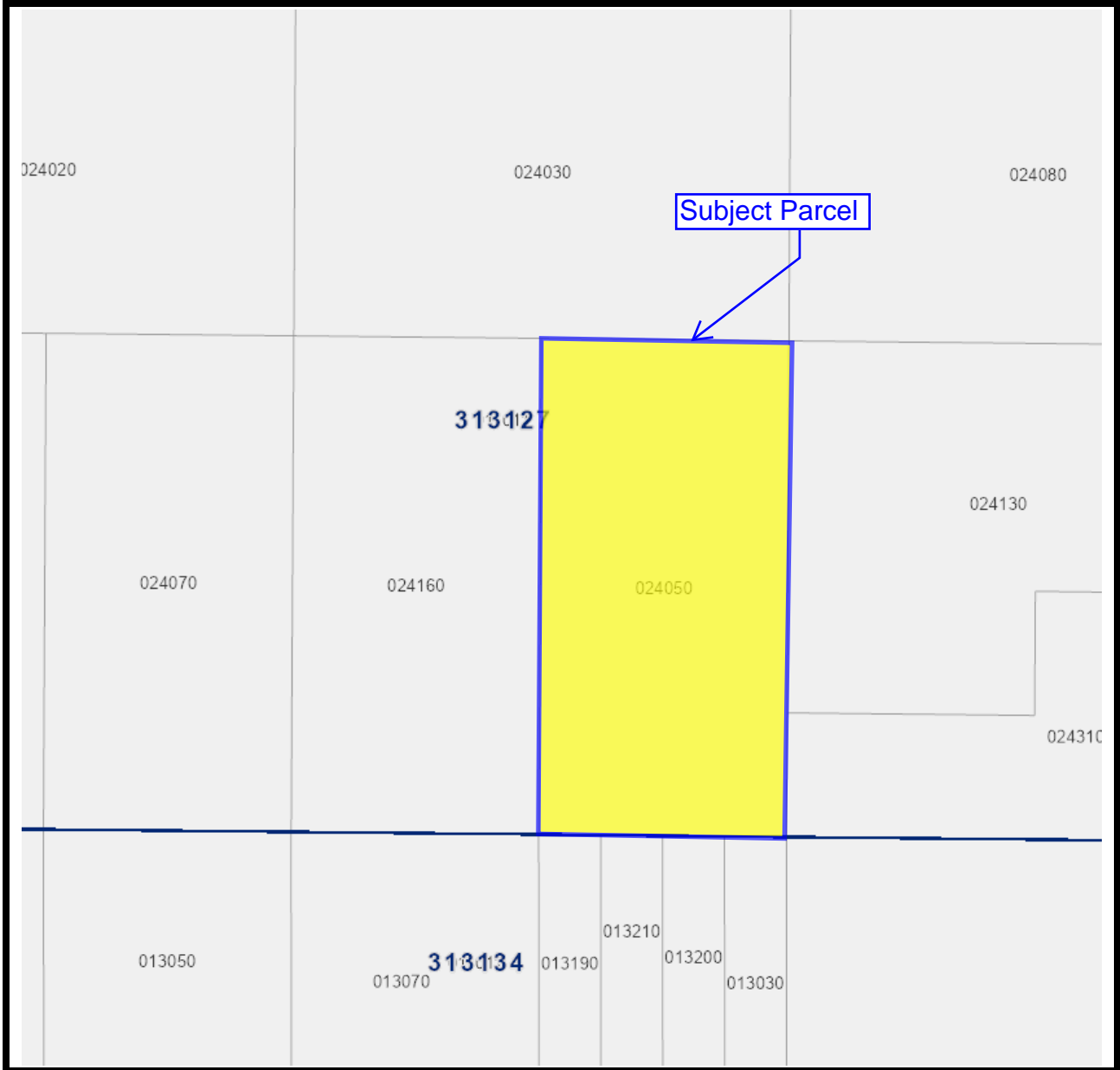

This Instrument prepared under the direction of:
R. Wade Allen, Director
Polk County Real Estate Services
P.O. Box 9005, Drawer RE-01
Bartow, Florida 33831-9005
By: Heather Fuentes *CE*
Conservation Preservation Donation
Parcel LD. Nos.: 313105-000000-012270/012280
313127-000000-024050

QUIT CLAIM DEED

THIS INDENTURE, made this 22 day of Nov, 2024, between **REBECCA LYNN LANTZ**, as Personal Representative of the Estate of **THOMAS EDWARD LANTZ**, deceased, whose mailing address is 2029 Silvastone Drive, NE, Atlanta, Georgia 30345-3739, Grantor, and **POLK COUNTY**, a political subdivision of the State of Florida, whose address is P.O. Box 988, Bartow, Florida 33831, Grantee.

(Wherever used herein the terms "Grantor" and "Grantee" may be singular or plural and/or natural or artificial, whenever the context so requires, and include all the parties to this instrument and the heirs, legal representatives and assigns of individuals, and the successors and assigns of business entities.)

WITNESSETH, that the said Grantor, for and in consideration of the sum of One Dollar, to her in hand paid by the said Grantee, the receipt whereof is hereby acknowledged, does hereby remise, release, quit claim, and convey unto the Grantee, its successors and assigns all right, title, interest, claim, and demand which the Grantor has in and to the following described lands, situate, lying and being in the County of Polk, State of Florida, to-wit:

SEE EXHIBIT "A"

TO HAVE AND TO HOLD THE SAME, together with all and singular the appurtenances thereto belonging or in anywise incident or appertaining, and all the estate, right, title, interest, and claim whatsoever of the said Grantor, in law or in equity to the only proper use, benefit, and behoove of the said Grantee, its successors and assigns forever.

The properties described herein do not constitute the homestead properties of the Grantor.

[SIGNATURE PAGE FOLLOWS]

[REMAINDER OF PAGE INTENTIONALLY LEFT BLANK]

IN WITNESS WHEREOF, said Grantor has hereunto set her hand and seal the date first above written.

Signed, Sealed and Delivered in the presence of:
(Signature of two witnesses required by Florida Law)

[Signature]
Witness

Print Name MAX H BAERMAN

Address 140 Altamont Drive Decatur, GA 30033

[Signature]
Witness

Print Name Linda M. Brannan

Address 3435 Fuys Walk, Atlanta, GA 30340

[Signature]

Rebecca Lynn Lantz, as Personal Representative of the Estate of Thomas Edward Lantz, deceased

STATE OF Georgia

COUNTY OF DeKalb

The foregoing instrument was acknowledged before me by means of physical presence or online notarization this 22 day of November, 2024 by Rebecca Lynn Lantz, as Personal Representative of the Estate of Thomas Edward Lantz, deceased, who is personally known to me or has produced drivers license as identification.

(AFFIX NOTARY SEAL)

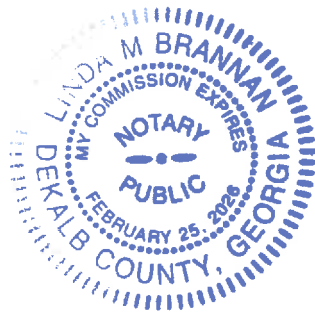

[Signature]
Notary Public

Print Name Linda M. Brannan

My Commission Expires 02/25/2026

EXHIBIT "A"

The East 1/2 of the Southwest 1/4 of the Southwest 1/4 of the Southeast 1/4 of the Northeast 1/4 of Section 5, Township 31 South, Range 31 East, Polk County, Florida. Parcel I.D. #313105-000000-012270.

The above being the same property described in that certain Personal Representative's Deed recorded in Official Records Book 3594 at Pages 2200 through 2203, Public Records of Polk County, Florida.

And

The West 1/2 of the Southeast 1/4 of the Southwest 1/4 of the Southeast 1/4 of the Northeast 1/4 of Section 5, Township 31 South, Range 31 East, Polk County, Florida. Parcel I.D. #313105-000000-012280.

The above being the same property described in that certain Personal Representative's Deed recorded in Official Records Book 3594 at Pages 536 through 539, Public Records of Polk County, Florida.

And

The East 1/2 of the Southeast 1/4 of the Southwest 1/4 of the Southwest 1/4 of the Southeast 1/4 of Section 27, Township 31 South, Range 31 East, Polk County, Florida. Parcel I.D. #313127-000000-024050.

The above being the same property described in that certain Personal Representative's Deed recorded in Official Records Book 3594 at Pages 2204 through 2207, Public Records of Polk County, Florida.